

Hexalobular Internal Driving Feature for Bolts and Screws

Excerpt from JIS B 1015:2018

Shape and dimensions of hexalobular socket for bolt and screw

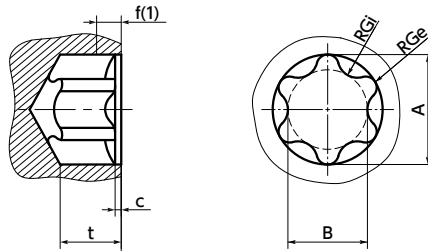

Note (1) The allowable depth f of broad mouth part is according to the table.

Hexalobular socket No.		3	4	5	6	8	10	15	20	25	27	30	40	45	50	55	
Nominal dimension (2)	A	1.2	1.35	1.5	1.75	2.4	2.8	3.35	3.95	4.5	5.1	5.6	6.75	7.93	8.95	11.35	
	B	0.85	1.0	1.1	1.27	1.75	2.05	2.4	2.85	3.25	3.68	4.05	4.85	5.64	6.45	8.05	
Allowable depth f of the mouth broad part		0.114	0.13	0.22	0.35	0.48	0.56	0.67	0.79	0.90	1.02	1.12	1.18	1.39	1.56	1.98	
Allowable limit dimensions of go-side gauge	A	Max/Min	1.145	1.305	1.430	1.709	2.349	2.776	3.309	3.893	4.465	5.024	5.557	6.687	7.856	8.872	11.259
			1.131	1.291	1.415	1.695	2.335	2.761	3.295	3.879	4.451	5.009	5.543	6.673	7.841	8.857	11.245
	B	Max/Min	0.815	0.927	1.028	1.224	1.686	1.993	2.367	2.778	3.185	3.578	3.972	4.780	5.570	6.380	7.945
			0.800	0.912	1.013	1.210	1.672	1.979	2.353	2.764	3.170	3.564	3.958	4.766	5.555	6.366	7.930
Gi	Max/Min	0.270	0.312	0.342	0.396	0.523	0.609	0.728	0.871	0.932	1.120	1.206	1.440	1.808	1.828	2.682	
		0.263	0.305	0.318	0.371	0.498	0.585	0.704	0.846	0.907	1.095	1.182	1.415	1.784	1.804	2.657	
Ge	Max/Min	0.085	0.093	0.111	0.134	0.193	0.231	0.269	0.307	0.378	0.393	0.454	0.548	0.576	0.777	0.769	
		0.078	0.087	0.107	0.130	0.188	0.227	0.265	0.303	0.371	0.387	0.448	0.544	0.572	0.773	0.765	
Allowable limit dimensions of not-go side gauge	A	Max/Min	1.222	1.382	1.506	1.785	2.425	2.852	3.385	3.970	4.566	5.126	5.659	6.814	7.983	8.999	11.412
			1.214	1.374	1.499	1.778	2.419	2.845	3.379	3.963	4.560	5.118	5.652	6.807	7.976	8.992	11.405
	B	Max.	0.790	0.917	1.044	1.181	1.664	1.956	1.956	2.616	2.868	3.275	3.886	4.661	4.661	6.413	7.684
			0.145	0.191	0.221	0.241	0.370	0.441	0.408	0.614	0.647	0.474	0.949	1.125	1.123	1.640	2.189
	Gi	Max./Min.	0.137	0.180	0.208	0.231	0.360	0.431	0.398	0.602	0.637	0.735	0.939	1.112	1.110	1.628	2.176
			0.130	0.140	0.157	0.180	0.238	0.276	0.315	0.353	0.436	0.452	0.513	0.619	0.648	0.848	0.853
Ge	Max./Min.	0.119	0.132	0.147	0.173	0.231	0.269	0.307	0.345	0.429	0.445	0.505	0.612	0.640	0.840	0.845	
		0.965	1.105	1.205	1.445	1.925	2.285	2.765	3.285	3.725	4.265	4.665	5.605	6.665	7.385	9.665	
Allowable limit dimensions of not-go side cylindrical gauge for the dimension B	Max./Min.	0.960	1.100	1.200	1.440	1.920	2.280	2.760	3.280	3.720	4.260	4.660	5.600	6.660	7.380	9.660	

Unit: mm

Note (2) The curve of hexalobular socket contour is determined by the gauge specified in the above table.

Remarks: 1. The bore depth c shall be 0.13 mm or smaller for hole No. 15 or smaller and 0.25 mm or smaller for hole over No. 15.

2. Sink depth t depends on respective product standard.

3. It is at the discretion of manufacturer as long as the hole bottom shape satisfies the allowable limit of sink depth t .

4. Hexalobular socket must be able to accept the go-side gauge down to the sink depth t specified by the applicable product standard without effort.

5. The not-go side gauge must be beyond the allowable depth f of the broad mouth part specified in the table.