

SPA-MC1 Plastic Cross Recessed Micro Pan Head Machine Screws - RENY - Type 1

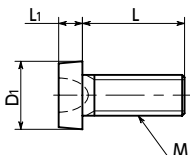

High strength Lightweight Miniature Size High Specific Strength



● Material/Finish



SPA-MC1	
Main Body	RENY™*1 (50% Glass Fiber Reinforced Polyamide MXD6) (Ivory)
Heat Resistance Temperature*2	105°C

*1: RENY™ is a trademark or registered trademark of Mitsubishi Gas Chemical Company, Inc.

*2: This is the value for the resin material. The operating temperature of the product changes with performance conditions such as tightening torque.

● Application

Heat insulation and dew condensation prevention of refrigerating and freezing facilities
Electrical and electronic equipment / Offshore instruments / Plating facilities

- RENY™ miniature screws for precision instruments (No. 0 Class 1).
- RENY™ is a thermoplastic engineering plastic with excellent tensile and bending strength.
- It is highly fatigue-resistant and has excellent creep and heat insulation properties.
- While it is nearly as strong as metal, its weight is approximately 1/5 of iron.
- For the properties and precautions for use of plastic screws, see "Properties of Plastic Screws."
- Mount and remove with **SKCHB** Dedicated Bits and **SRD** Dedicated Magnetic Screwdriver.

Unit : mm

Part Number 1	M (Coarse)		L 2							D1	L1	Bit Part No.	Tensile Breaking Load*1 (N)	Torsional Torque*1 (N·m)	Mass (g)	Qty per Pack	
	Nominal of Thread	Pitch															
SPA-M1.2-MC1	M1.2	0.25	1.5	1.8	2	2.5	3	3.5	4	1.8	0.5	SKCHB-M1.2	102	0.031	0.038 - 0.04	10	
SPA-M1.2-MC1(100)	M1.2	0.25	1.5	1.8	2	2.5	3	3.5	4	1.8	0.5	SKCHB-M1.2	102	0.031	0.038 - 0.04	100	
SPA-M1.4-MC1	M1.4	0.3			2	2.5	3	3.5	4	6	2	0.5	SKCHB-M1.4	126	0.034	0.048 - 0.05	10
SPA-M1.4-MC1(100)	M1.4	0.3			2	2.5	3	3.5	4	6	2	0.5	SKCHB-M1.4	126	0.034	0.048 - 0.05	100
SPA-M1.6-MC1	M1.6	0.35			2	2.5	3	3.5	4	6	2.3	0.5	SKCHB-M1.6	143	0.046	0.078 - 0.08	10
SPA-M1.6-MC1(100)	M1.6	0.35			2	2.5	3	3.5	4	6	2.3	0.5	SKCHB-M1.6	143	0.046	0.078 - 0.08	100

*1: Values in chart are for reference only. They are not guaranteed values. The recommended tightening torque is 50% of the torsional torque.

● When purchasing less volume than one full bag, a separate handling fee is charged. For details, see the Sold Separately Service.

● Related Products

Mount and remove with **SKCHB** Dedicated Bits and **SRD** Dedicated Magnetic Screwdriver.
Dedicated Bits **SKCHB**



Dedicated Magnet Screwdrivers **SRD**



● Part Number Specification

SPA-M1.2-2-MC1

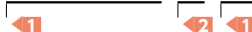

1 Individual Sales Available / Add'l charge	1 Cleanroom Wash & Packaging Available / Add'l charge	1 Screw Length Adjustment Not Available	1 Vibration Resistant Not Available	1 Modification process for captive use Not Available
--	--	--	--	---