

# SPEG-C Plastic Screws - Hex Socket Head Cap Screws - PEEK GF30

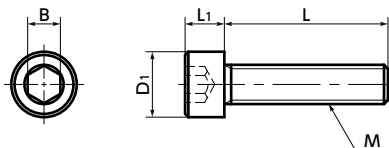

- Heat-resistance
- Chemical-proof
- High strength
- Electrical Insulation
- High Specific Strength



● Material/Finish



	<b>SPEG-C</b>
Main Body	PEEK GF30 (PEEK Containing Glass Fiber) (Light Brown) (Glass Fiber 30%)
Heat Resistance Temperature*1	260°C

\*1: This is the value for the resin material. The operating temperature of the product changes with performance conditions such as tightening torque.

● Knurling on the head of **SPEG-C** has been eliminated in order to distinguish it from PEEK hex socket head cap screw **SPE-C** that contains no glass fiber.

**SPEG-C**

**SPE-C**



Precautions for Use

Because a cumulative pitch difference is created when PEEK screws are manufactured, use a 20 mm or less fit with female thread.

- Hex socket head cap screws made of PEEK containing glass fiber for increased strength. The tensile strength of the material is approximately 1.7 times that of ordinary PEEK.
- PEEK is a thermoplastic super engineering plastic superior in physical and chemical properties.
- Excellent chemical resistance. It remains almost unaffected by chemicals other than concentrated sulfuric acid, concentrated nitric acid, and concentrated hydrofluoric acid.
- With excellent heat resistance and water resistance, it retains strength at high temperatures.
- It features outstanding resistance to wear, shock, and fatigue.
- It also has high flame retardance which clears the UL 94 V-0 standard.
- The properties and precautions of plastic screws → P.xxxx
- Application

FPD production equipment / Semiconductor devices / Printed circuit board etching devices / Metallic surface treatment equipment and facilities / Chemical plants / Transformers / Electrical and electronic equipment / Hot water pumps / Chemical pumps

Unit : mm

Part Number	M (Coarse)		L	D1	L1	B	Tension Rupture Load*1 (N)	Torsional Torque*1 (N·m)	Mass (g)	Qty per Pack
	Nominal of Thread	Pitch								
<b>SPEG-M3-C</b>	M3	0.5	6 8 10 12 15 20 25	5.5	3	2.5	532	0.27	0.14 - 0.29	10
<b>SPEG-M4-C</b>	M4	0.7	6 8 10 12 15 20 25 30	7	4	3	909	0.64	0.29 - 0.70	10
<b>SPEG-M5-C</b>	M5	0.8	6 8 10 12 15 20 25 30	8.5	5	4	1756	1.45	0.44 - 1.01	10

\*1: Values in chart are for reference only. They are not guaranteed values. The recommended tightening torque is 50% of the torsional torque.

● When purchasing less volume than one full bag, a separate handling fee is charged. For details, see the Sold Separately Service.

● Part number specification

**SPEG-M3-10-C**



- Individual Sales → P.xxxx
  - Cleanroom Wash & Packaging → P.xxxx
  - Screw Length Adjustment → P.xxxx
  - Vibration Resistant → P.xxxx
  - Modification process for captive use → P.xxxx
- Available / Add'l charge    Available / Add'l charge    Available / Add'l charge    Not Available    Please feel free to contact us