

# SVLS Socket Head Cap Screws with Ventilation Hole with Low Profile

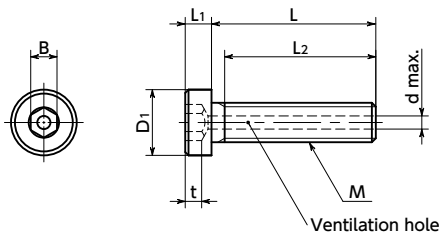

Vacuum Protrusion Cleanroom wash & packaging SUS Stainless steel



● Material/Finish



|                |                               |
|----------------|-------------------------------|
|                | <b>SVLS</b>                   |
| Main Body      | SUSXM7 (Equivalent to SUS304) |
| Strength Class | A2-50                         |

- The ventilation hole easily releases gas trapped in the screw holes of equipment and machines, and supports vacuum drawing of vacuum devices.
- Hex socket head cap screw with low profile. For space-saving of equipment/devices and applications with limited overhead space.
- Cleanroom wash/cleanroom packing provided.

● Application

Vacuum devices, vacuum chambers, FPD production equipment, semiconductor devices, and electron microscopes

Unit : mm

| Part Number     | M (Coarse)        |       | L |   |   |    |    |    |    |    |    |    |    | D1 | L1 | B*1 | t   | L2*2 | d   | Mass (g) | Qty per Pack |     |             |    |
|-----------------|-------------------|-------|---|---|---|----|----|----|----|----|----|----|----|----|----|-----|-----|------|-----|----------|--------------|-----|-------------|----|
|                 | Nominal of Thread | Pitch | 5 | 6 | 8 | 10 | 12 | 16 | 20 | 25 | 30 | 35 |    |    |    |     |     |      |     |          |              |     |             |    |
| <b>SVLS-M3</b>  | M3                | 0.5   | 5 | 6 | 8 | 10 | 12 |    |    |    |    |    |    |    |    |     | 5.5 | 2    | 2   | 1.5      | Full Thread  | 1.2 | 0.49 - 0.78 | 20 |
| <b>SVLS-M4</b>  | M4                | 0.7   |   | 6 | 8 | 10 | 12 | 16 |    |    |    |    |    |    |    |     | 7   | 2.8  | 2.5 | 2.3      | Full Thread  | 1.5 | 1.1 - 1.9   | 20 |
| <b>SVLS-M5</b>  | M5                | 0.8   |   |   | 8 | 10 | 12 | 16 | 20 |    |    |    |    |    |    |     | 8.5 | 3.5  | 3   | 2.7      | Full Thread  | 1.5 | 1.8 - 3.3   | 10 |
| <b>SVLS-M6</b>  | M6                | 1     |   |   |   | 8  | 10 | 12 | 16 | 20 |    |    |    |    |    |     | 10  | 4    | 4   | 3        | Full Thread  | 2   | 3.1 - 5.3   | 10 |
| <b>SVLS-M8</b>  | M8                | 1.25  |   |   |   |    | 10 | 12 | 16 | 20 | 25 | 30 | 35 |    |    |     | 13  | 5    | 5   | 3.8      | 22(L=35)     | 2   | 7.2 - 16    | 10 |
| <b>SVLS-M10</b> | M10               | 1.5   |   |   |   |    |    |    | 16 | 20 | 25 | 30 |    |    |    |     | 16  | 6    | 6   | 4.5      | Full Thread  | 3   | 15 - 22     | 5  |

\*1 : The hex socket width across flat of **SVLS-M10** has been changed from 7 mm to 6 mm.

\*2 : If the "L" value is not in parentheses, the screw is full thread.

● When purchasing less volume than one full bag, a separate handling fee is charged. For details, see the Sold Separately Service.

● Usage Example

Effective with vacuum devices and vacuum chambers that require the exhaustion of gas trapped in screw holes.

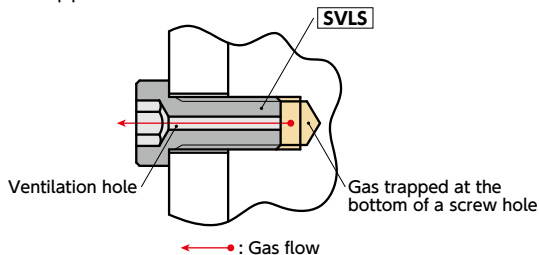

● Related Products

For ventilation of drilled holes, please use **SWAS-VF**.



● Part Number Specification

**SVLS-M5-20**

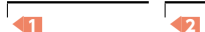

|                          |                             |                          |                     |                                      |
|--------------------------|-----------------------------|--------------------------|---------------------|--------------------------------------|
| Individual Sales         | Cleanroom Wash & Packaging  | Screw Length Adjustment  | Vibration Resistant | Modification process for captive use |
| Available / Add'l charge | Cleanroom washed and packed | Available / Add'l charge | Not Available       | Please feel free to contact us       |