

# SVFS Cross Recessed Flat Head Machine Screws with Ventilation Hole

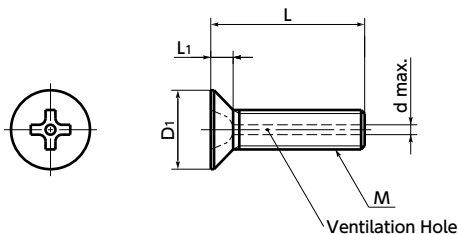

Vacuum Protrusion Cleanroom wash & packaging SUS Stainless steel



- The ventilation hole easily releases gas trapped in the screw holes of equipment and machines, and supports vacuum drawing of vacuum devices.
- The flat head does not protrude after tightening.
- Cleanroom wash and cleanroom packing are completed.

### • Application

Vacuum devices, vacuum chambers, FPD production equipment, semiconductor devices, and electron microscopes

### • Material/Finish



	SVFS
Main Body	SUSXM7 (Equivalent to SUS304)

Unit : mm

Part Number <span style="color:red">1</span>	M (Coarse)		L <span style="color:red">2</span>								D1	L1	d	Cross-recessed Socket Number	Mass (g)	Qty per pack	
	Nominal of Thread	Pitch	3	4	5	6	8	10	12	16							20
<b>SVFS-M2</b>	M2	0.4	3	4	5	6	8					4	1.2	0.8	1	0.13 - 0.21	10
<b>SVFS-M2.6</b>	M2.6	0.45		4	5	6	8	10				5.2	1.5	1	1	0.27 - 0.46	10
<b>SVFS-M3</b>	M3	0.5			5	6	8	10	12			6	1.75	1.2	2	0.49 - 0.77	20
<b>SVFS-M4</b>	M4	0.7				6	8	10	12	16		8	2.3	1.5	2	1 - 1.8	20
<b>SVFS-M5</b>	M5	0.8					8	10	12	16		10	2.8	1.5	2	2.2 - 3.1	10
<b>SVFS-M6</b>	M6	1						10	12	16	20	12	3.4	2	3	3.9 - 5.6	10

• When purchasing less volume than one full bag, a separate handling fee is charged. For details, see the Sold Separately Service.

### • Usage example

Effective with vacuum devices and vacuum chambers that require the exhaustion of gas trapped in screw holes.

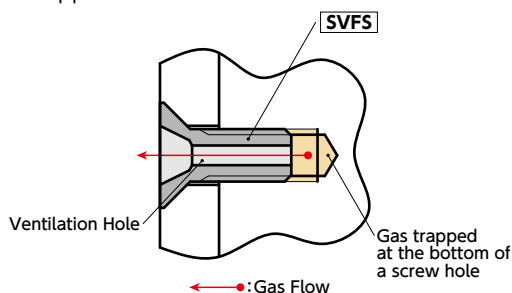

### • Part number specification

**SVFS-M4-12**

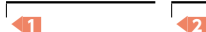

Individual Sales	Cleanroom Wash & Packaging	Screw Length Adjustment	Vibration Resistant	Modification process for captive use
Available / Add'l charge	Cleanroom washed and packed	Available / Add'l charge	Not Available	Not Available