

SNSL-UCL Hex Socket Head Cap Screws (SUS316L / Cleanroom Washing/Cleanroom Packing)

Cleanroom wash & packaging Chemical-proof Non-Magnetic SUS Stainless steel

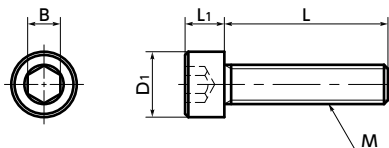

● Material/Finish



	SNSL-UCL
Main Body	SUS316L USC Cleaning
Strength Class	A4 - 70

- SUS316L hex socket head cap screw.
- Compared to SUS304, SUS316L has excellent hydrogen embrittlement resistance, fluorine and chlorine gas resistance, and heat resistance. This screw also has corrosion resistance against chemical products and seawater environments that matches or exceeds SUS304.
- SUS316L is non-magnetic.
- SUS316L is a stainless steel made by adding Mo to SUS304, so it has high pitting resistance and oxidation resistance. Due to its reduced carbon, it also has high intergranular corrosion resistance.
- Because the basic components include Mo, the strength is high even at high temperatures.
- Cleanroom wash/cleanroom packing provided.
- For parts embedded in FPD production devices, semiconductor manufacturing devices, medical equipment, or food machinery, or used in cleanrooms.
- Conforms to JIS B 1176, ISO 4762, and DIN 912.

● Application

FPD manufacturing equipment / Semiconductor manufacturing equipment / Medical equipment / Food related machinery

Unit : mm

Part Number ¹	M (Coarse)		L ²										D1	L1	B	Mass (g)	Qty per Pack	
	Nominal of Thread	Pitch																
SNSL-M3-UCL	M3	0.5	5	6	8	10	12	16						5.5	3	2.5	0.67 - 1.2	10
SNSL-M4-UCL	M4	0.7	5	6	8	10	12	16	20	25				7	4	3	1.4 - 3.2	10
SNSL-M5-UCL	M5	0.8		6	8	10	12	16	20	25				8.5	5	4	2.2 - 4.8	10
SNSL-M6-UCL	M6	1			8	10	12	16	20	25	30		10	6	5	4.3 - 8.3	10	

● When purchasing less volume than one full bag, a separate handling fee is charged. For details, see the Sold Separately Service.

● Part Number Specification

SNSL-M5-25-UCL



1 Individual Sales	Cleanroom Wash & Packaging	Screw Length Adjustment	Vibration Resistant	Modification process for captive use
Available / Add'l charge	Cleanroom washed and packed	Available / Add'l charge	Not Available	Not Available