



SKEIBD-SET Stripped Screw Removal Bits / Impact Screwdrivers Sets

| Part Number*1 | Mass *2 (g) |
|-----------------|-------------|
| SKEIBD-6.35-SET | 704 |

*1: SKEIB, SKEIB-SPH, SKEIB-MPH, SKEID and Storage Case products are part of a set.
Storage Case Outer Dimensions W: 275 mm / H: 45 mm / D: 131 mm

*2: Total mass of the tool and Storage Case.

Application

For stripped screws that cannot be removed with an ordinary tool

Material/Finish

| | SKEIB |
|------------|---|
| Shaft Part | Alloy Steel Zinc Phosphate Film |
| Grip | Thermoplastic Elastomer + Polypropylene Blended Molding |

| | SKEID |
|--------------------|--|
| Impact Screwdriver | Carbon Steel Chrome Plating |
| Grip | Thermoplastic Elastomer |
| Adapter | Alloy Steel Ferrosferric Oxide Film (Black) |
| Adapter Coating | Polyamide (Black) |

| | Storage Case |
|-----------------------------|----------------------------------|
| Exterior Case/Interior Tray | Polypropylene (Semi-Transparent) |

- A tool that can remove cross-recessed head machine screws and hex socket head cap screws with crushed or stripped recesses that cannot be removed by ordinary tools.
- The dedicated bit SKEIB is used to make grooves in damaged recesses which can be used to turn and remove the screws. For details, refer to "How to Remove Screws".

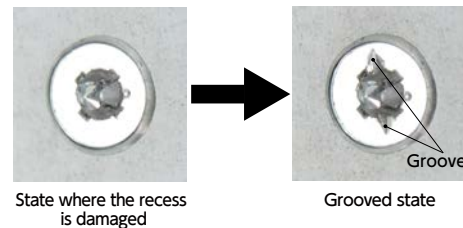

- Use it with the dedicated bit SKEIB for making grooves and the impact screwdriver SKEID for turning the screw in the direction of loosening by applying impact.
- Can also remove flat head screws that cannot be gripped with a tool such as a wrench or screws in counterbored holes.
- Compatible with 2 types of recesses: hexagonal and cross-recessed.
 - SKEIB For Hex Sockets
 - SKEIB-SPH SKEIB-MPH For Cross-Recessed Sockets
- SKEIB, SKEIB-SPH, SKEIB-MPH and SKEID can be purchased individually. → P.xxxx

⚠ Precautions for Use

- Do not use for purposes other than removing screws with damaged recesses.
- Use SKEIB in combination with SKEID.
- Use a bit suitable for the recess of the screw.
- Do not use SKEIB-SPH SKEIB-MPH for screws with high surface hardness due to heat treatment. The bit may be damaged.
- Hitting with a hammer will transmit the impact to the part where the screw is attached. The impact may be absorbed without creating a groove, or the mounting area may be damaged.
- Do not use for screws with low recess strength such as resin screws, as they may be damaged further.
- Striking with excessive force may damage the screw further, or damage the bit.
- The tip of SKEIB is sharp, so be careful to avoid injury.
- When using a hammer, be careful not to accidentally hit your hands or fingers.
- Do not use in locations exposed to live wires, as it is made of metal.
- Be sure to wear safety glasses while working.

Set Contents

SKEIB Bit for hex sockets

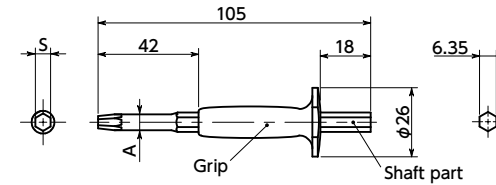

| Part Number | S | A | Mass (g) |
|-------------|--|-----|----------|
| | Nominal of Applicable Hexagonal Width Across Flats | | |
| SKEIB-1.5 | 1.5 | 2.3 | 24 |
| SKEIB-2 | 2 | 3 | 24 |
| SKEIB-2.5 | 2.5 | 3.9 | 25 |
| SKEIB-3 | 3 | 4.5 | 26 |
| SKEIB-4 | 4 | 6 | 29 |

SKEIB-SPH Bit for cross-recessed sockets (supports M2-M4 thread diameter)

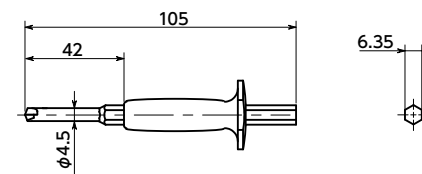

SKEIB-MPH Bit for cross-recessed sockets (supports M3-M6 thread diameter)

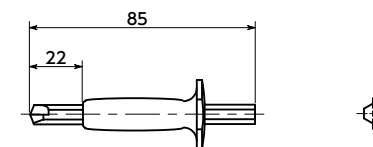

| Part Number | Applicable Thread Diameter | Mass (g) |
|-------------|----------------------------|----------|
| SKEIB-SPH | M2 - M4 | 26 |
| SKEIB-MPH | M3 - M6 | 25 |

SKEID Impact screwdriver

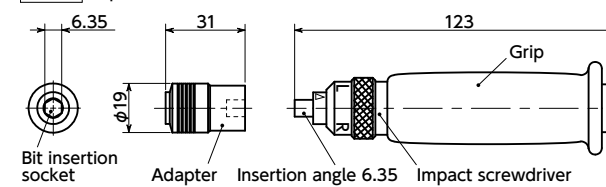

| Part Number | Mass (g) |
|-------------|----------|
| SKEID-6.35 | 239 |

How to Remove Screws

- ① Place the applicable stripped screw removal bit SKEIB vertically to the damaged recess and hit the end of the shaft with a hammer to form a groove on the screw head.

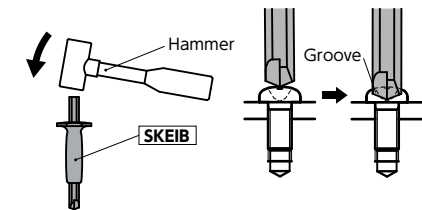

- ② Mount SKEIB on the impact screwdriver SKEID. Place the SKEIB tip vertically against the groove made in the screw head, firmly hold the SKEID grip, and hit the end with a hammer to rotate the SKEID tip up to 45°*1 and loosen the screw.

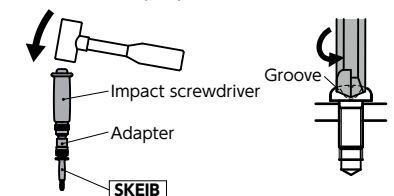

*1: Gently push the SKEID adapter in while turning it, and align the Δ mark in the loosening direction. L left rotation / R right rotation

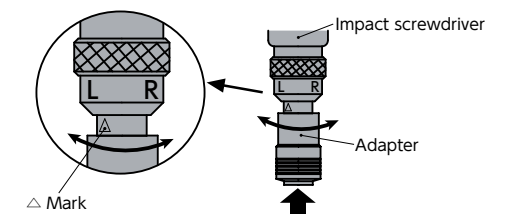

- The rotational direction of SKEID may change depending on the impact. To avoid this, hammer while applying force in the desired direction.

- ③ Make sure that the screw is loosened and turn SKEID by hand to remove the screw.

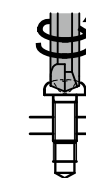

Part number specification

SKEIBD-6.35-SET

