

SSCPL Phillips Pan Head Captive Screws - SUS316L

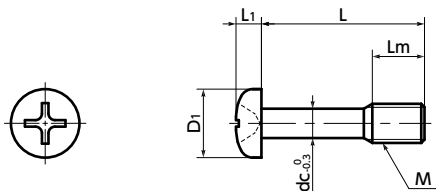

Heat-resistance Chemical-proof Non-Magnetic SUS Stainless steel



● Material/Finish



	SSCPL
Main Body	SUS316L
Strength Class	A4-50

● Installation Example

Make a screw hole in the cover, and then pass the **SSCPL** thread part through it. Even when the screw is removed from the frame, **SSCPL** does not fall out of the cover because the **SSCPL** thread part catches on the cover screw hole.

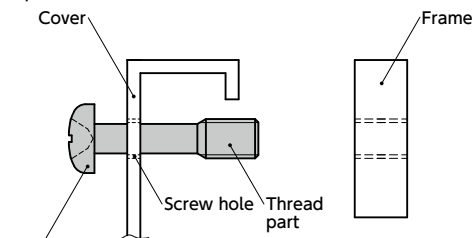

SSCPL Cross recessed pan head captive machine screw

⚠ Precautions for Use

- Screw hole inner diameter on the cover side shall be at least the dc dimension.
- The cover thickness should be 0.8mm or above.



- Prevents fall-off and loss of the screw. They are intended to fix protective and inspection covers that are frequently installed and removed.
- For CE Marking compatibility.
- This screw has corrosion resistance against chemical products and seawater environments that matches or exceeds SUS304.
- SUS316L is non-magnetic.

● Application

For fixing protective covers and maintenance covers
 CE Marking compatible
 Machine tools / Food machinery / Electrical and electronic equipment

Unit : mm

Part Number	M (Coarse)		L	Lm	D1	L1	dc	Cross-recessed Socket No.	Mass (g)
	Nominal of Thread	Pitch							
SSCPL-M3	M3	0.5	8 10 12 16	4	5.5	2	2.2 2	0.61 - 0.94	
SSCPL-M4	M4	0.7	10 12 16 20	5	7	2.6 3	2	1.3 - 2.1	
SSCPL-M5	M5	0.8	12 16 20 25	6	9	3.3 3.9	2	2.7 - 4.2	
SSCPL-M6	M6	1	12 16 20 25 30	8	10.5	3.9 4.6	3	4.3 - 7.4	
SSCPL-M8	M8	1.25	16 20 25 30 35 40	10	14	5.2 6.3	3	10 - 18	

● Part Number Specification

SSCPL-M5-20



1 Individual Sales 1 piece in 1 pack	2 Cleanroom Wash & Packaging Available / Add'l charge	3 Screw Length Adjustment Not Available	4 Vibration Resistant Not Available	5 Modification process for captive use with Captive Processing
--	---	---	---	--