

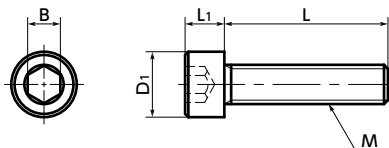

# SNSP Hex Socket Head Cap Screws - Phosphor Bronze

Cleanroom wash & packaging Non-Magnetic



## ● Mechanical Properties

	Phosphor Bronze (C5191)	SUS304
Tensile Strength (N/mm <sup>2</sup> )	590 or Higher	520 or Higher
Elongation (%)	8	40 or Higher

● Values in chart are for reference only. They are not guaranteed values.

## ● Physical Properties

	Phosphor Bronze (C5191)	SUS304
Specific Gravity	8.83	7.93
Longitudinal Elastic Modulus (GPa)	105	193
Electric Resistance ( $\mu\Omega \cdot m$ )	0.13	0.7
Thermal Conductivity (W/(m·K))	67	17
Linear Expansion Coefficient (K <sup>-1</sup> )	$18 \times 10^{-6}$	$17.3 \times 10^{-6}$

● Values in chart are for reference only. They are not guaranteed values.

## ● Magnetic flux density

	Phosphor Bronze	SUSXM7 (Equivalent to SUS304)
Magnetic Flux Density (T)	0	$5 \times 10^{-5}$

Measuring device: 5080 Gauss (Tesla) Meter by F.W.BELL

Measuring conditions: DC magnetic field measurement mode

Probe and sample separation distance: 5 mm

- Non-magnetic.
- Excellent resistance to fatigue, corrosion, and abrasion.
- Cleanroom wash/cleanroom packing provided.
- Equivalent to JIS B 1176, ISO 4762, and DIN 912.

## ● Application

FPD production equipment, semiconductor devices, and electrical and electronic equipment

## ● Material/Finish



	SNSP
Main Body	C5191 (Phosphor Bronze)

Part Number <sup>1</sup>	M (Coarse)		L <sup>2</sup>													D1	L1	B	Tensile Breaking Load *1 (N)	Mass (g)	
	Nominal of Thread	Pitch	4	5	6	8	10	12	16	20	25	30	35	13	8						6
<b>SNSP-M2</b>	M2	0.4	4	5	6	8											3.8	2	1.5	1310	0.22 - 0.29
<b>SNSP-M2.5</b>	M2.5	0.45	4	5	6	8	10										4.5	2.5	2	2150	0.39 - 0.61
<b>SNSP-M3</b>	M3	0.5			6	8	10	12	16	20							5.5	3	2.5	2960	0.81 - 1.6
<b>SNSP-M4</b>	M4	0.7				8	10	12	16	20	25						7	4	3	5180	1.9 - 3.6
<b>SNSP-M5</b>	M5	0.8					10	12	16	20	25						8.5	5	4	8370	3.1 - 5.4
<b>SNSP-M6</b>	M6	1						12	16	20	25	30					10	6	5	11800	5.8 - 9.5
<b>SNSP-M8</b>	M8	1.25								16	20	25	30	35			13	8	6	21500	14 - 22

Unit : mm

\*1 : Values in chart are for reference only. They are not guaranteed values.

## ● Part number specification

### SNSP-M5 - 16

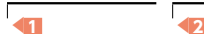

Batch cleanroom packing is provided for orders containing multiple items of the same size.

Individual Sales	Cleanroom Wash & Packaging	Screw Length Adjustment	Vibration Resistant	Modification process for captive use
1 piece in 1 pack	Cleanroom washed and packed	Available / Add'l charge	Available / Add'l charge	Available / Add'l charge