

# SNSMT Hex Socket Head Cap Screws (MAT21) **NEW**

[WEB Selection Tool](#)
[WEB CAD Download](#)
[Cleanroom wash & packaging](#)
[Chemical-proof](#)

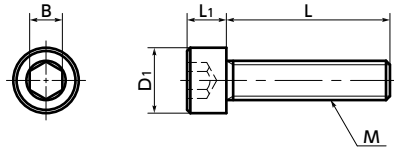

• Engraved on the top of the head to distinguish it from other materials

• Material/Finish

RoHS2 Compliant

SNSMT	
Main Body	UNS N06210 (MAT21 *1)

\*1: MAT and MAT21 are registered trademarks of Hitachi Metals, Ltd.

- Corrosion resistant alloy steel MAT21 hex socket head cap screws.
- MAT21 demonstrates excellent corrosion resistance in both oxidizing and reducing environments. → P.xxxx
- In a wide range of corrosive environments, it demonstrates better corrosion resistance than Hastelloy \*1 C-22 and C-276.
- Cleanroom wash/cleanroom packing provided. → P.xxxx

\*1: Hastelloy is a registered trademark of Haynes International, Inc.

• Application

FPD production equipment / Semiconductor devices / Printed circuit board etching devices / Metallic surface treatment equipment and facilities / Chemical plants

Unit : mm

Part Number	M (Coarse)		L													D1	L1	B	Tension Rupture Load *1 (N)	Mass (g)	Qty per Pack	
	Nominal of Thread	Pitch	6	8	10	12	16	20														
<b>SNSMT-M3</b>	M3	0.5	6	8	10	12	16	20									5.5	3	2.5	3470	0.8 - 1.5	1
<b>SNSMT-M4</b>	M4	0.7	8	10	12	16	20	25									7	4	3	6050	1.8 - 3.5	1
<b>SNSMT-M5</b>	M5	0.8		10	12	16	20	25									8.5	5	4	9790	3 - 5.3	1
<b>SNSMT-M6</b>	M6	1			12	16	20	25	30								10	6	5	13800	5.6 - 9.3	1
<b>SNSMT-M8</b>	M8	1.25				16	20	25	30	35							13	8	6	25200	13 - 21	1

\*1: Values in chart are for reference only. They are not guaranteed values.

• Mechanical property

	MAT21 (UNS N06210)	SUS304
Tensile Strength (N/mm <sup>2</sup> )	690	520 or More
0.2% Proof Load (N/mm <sup>2</sup> )	310	205 or More
Elongation (%)	45	40 or More

• Values in chart are for reference only. They are not guaranteed values.

• Physical property

	MAT21 (UNS N06210)	SUS304
Specific Gravity	8.76	7.93
Longitudinal Elastic Modulus (GPa)	205	193
Specific Heat (J/kg·K)	414	500
Electric Resistance (μΩ·m)	1.274	0.7
Linear Expansion Coefficient (K <sup>-1</sup> )	12.0 x 10 <sup>-6</sup>	17.3 x 10 <sup>-6</sup>

• Values in chart are for reference only. They are not guaranteed values.

• Chemical Resistance

Chemical Name	Composition (%)	Temperature	MAT21 (UNS N06210)	Hastelloy C-22	Hastelloy C-276	SUS316L
HCl	1	Boiling Point	⊙	○	○	×
	2	Boiling Point	⊙	×	△	×
	4	Boiling Point	△	×	×	—
	5	Boiling Point	△	×	×	—
H <sub>2</sub> SO <sub>4</sub>	10	Boiling Point	⊙	○	△	×
	40	Boiling Point	△	×	×	—
Mixed Fluids	H <sub>2</sub> SO <sub>4</sub>	10				
	HCl	2	△	×	×	—
Mixed Fluids	H <sub>2</sub> SO <sub>4</sub>	20				
	HCl	1.5	80°C	⊙	×	△
Mixed Fluids	H <sub>2</sub> SO <sub>4</sub>	50				
	HCl	1.5	50°C	○	○	○
HNO <sub>3</sub>	10	Boiling Point	⊙	⊙	○	—
H <sub>3</sub> PO <sub>4</sub>	85	Boiling Point	○	×	×	×
Method B	※	Boiling Point	○	⊙	△	×

※ 23.0% sulfuric acid + 1.2% hydrochloric acid + 1% iron (III) chloride + 1% copper (II) chloride

- ⊙ : <0.127 mm/year
- : 0.127 - 0.508 mm/year
- △ : 0.508 - 1.27 mm/year
- × : >1.27 mm/year

• Values in chart are for reference only. They are not guaranteed values.

• Part number specification

**SNSMT-M4-16**

1 2

Please contact our customer service for the price and delivery time.

[Individual Sales](#) → P.xxxx
 [Cleanroom Wash & Packaging](#) → P.xxxx
 [Screw Length Adjustment](#) → P.xxxx
 [Vibration Resistant](#) → P.xxxx
 [Modification process for captive use](#) → P.xxxx

1 unit in 1 bag | Cleanroom washed and packed | Please feel free to contact us | Please feel free to contact us | Please feel free to contact us