

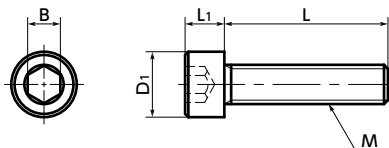

# SNSM Hex Socket Head Cap Screws - Molybdenum

Cleanroom wash &amp; packaging Heat-resistance



## ● Material/Finish



	SNSM
Main Body	Pure Molybdenum

## ● Mechanical Properties

	Pure Molybdenum	SUS304
Tensile Strength (N/mm <sup>2</sup> )	515	520 or Higher
0.2% Proof Load (N/mm <sup>2</sup> )	380	205 or Higher
Elongation (%)	15	40 or Higher

● Values in chart are for reference only. They are not guaranteed values.

## ● Physical Properties

	Pure Molybdenum	SUS304
Specific Gravity	10.2	7.93
Longitudinal Elastic Modulus (GPa)	327	193
Electric Resistance ( $\mu\Omega \cdot m$ )	0.058	0.7
Thermal Conductivity (W/(m·K))	142	17
Linear Expansion Coefficient (K <sup>-1</sup> )	$5.1 \times 10^{-6}$	$17.3 \times 10^{-6}$

● Values in chart are for reference only. They are not guaranteed values.

- These screws are made of pure molybdenum.
- Melting Point: 2623 deg C. Excellent heat resistance.
- Cleanroom wash and cleanroom packing are completed.
- Equivalent to JIS B 1176, ISO 4762, and DIN 912.

## ● Application

Sputtering equipment and high temperature furnaces

## ⚠ Precautions for Use

Note that in an oxidizing atmosphere, sublimation will begin at 600°C or higher.

Unit : mm

Part Number	M (Coarse)		L													D1	L1	B	Tensile Breaking Load *1 (N)	Mass (g)
	Nominal of Thread	Pitch																		
<b>SNSM-M3</b>	M3	0.5	6	8	10	12	16	20								5.5	3	2.5	2760	0.93 - 1.8
<b>SNSM-M4</b>	M4	0.7	6	8	10	12	16	20	25							7	4	3	4820	2 - 4.1
<b>SNSM-M5</b>	M5	0.8			10	12	16	20	25							8.5	5	4	7810	3.5 - 6.3
<b>SNSM-M6</b>	M6	1				12	16	20	25	30						10	6	5	11000	6.6 - 11
<b>SNSM-M8</b>	M8	1.25					16	20	25	30	35					13	8	6	20100	16 - 25

\*1 : Values in chart are for reference only. They are not guaranteed values.

## ● Part Number Specification

### SNSM-M5-16



Batch cleanroom packing is provided for orders containing multiple items of the same size.

Individual Sales 1 piece in 1 pack	Cleanroom Wash & Packaging Cleanroom washed and packed	Screw Length Adjustment Available / Add'l charge	Vibration Resistant Available / Add'l charge	Modification process for captive use Available / Add'l charge
---------------------------------------	-----------------------------------------------------------	-----------------------------------------------------	-------------------------------------------------	------------------------------------------------------------------