

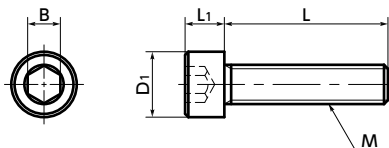

SNSTA Hex Socket Head Cap Screws (Tantalum)

Cleanroom wash & packaging Chemical-proof



● Material/Finish



	SNSTA
Main Body	Tantalum

● Mechanical property

	Tantalum	SUS304
Tensile Strength (N/mm ²)	271	520 or More
0.2% Proof Load (N/mm ²)	189	205 or More
Elongation (%)	51.2	40 or More

● Values in chart are for reference only. They are not guaranteed values.

● Physical property

	Tantalum	SUS304
Specific Gravity	16.65	7.93
Longitudinal Elastic Modulus (GPa)	185	193
Specific Heat (J/kg·K)	140	500
Linear Expansion Coefficient (K ⁻¹)	6.4 × 10 ⁻⁶	17.3 × 10 ⁻⁶

● Values in chart are for reference only. They are not guaranteed values.

- Tantalum hex socket head cap screws.
- Tantalum is a material characterized by excellent chemical resistance and high specific gravity.
- With excellent corrosion resistance to strong acids such as sulfuric acid, it is also resistant to aqua regia.
- The specific gravity is approximately twice that of general steel and stainless steel.
- Cleanroom wash/cleanroom packing provided. ➔ P. XXXX

● Application

FPD production equipment / Semiconductor manufacturing equipment / Printed circuit board etching devices / Metallic surface treatment equipment and facilities / Chemical plants

Unit : mm

Part Number 1	M (Coarse)		L 2				D1	L1	B	Tensile Breaking Load *1 (N)	Mass (g)
	Nominal of Thread	Pitch									
SNSTA-M3	M3	0.5	6	8	10		5.5	3	2.5	1360	1.5 - 1.9
SNSTA-M4	M4	0.7		8	10	12	7	4	3	2370	3.4 - 4
SNSTA-M5	M5	0.8			10	12	8.5	5	4	3840	6.3 - 8.8
SNSTA-M6	M6	1				12	10	6	5	5440	11 - 13

*1: Values in chart are for reference only. They are not guaranteed values.

● Part number specification

SNSTA-M5-16



Batch cleanroom packing is provided for orders containing multiple items of the same size.

Individual Sales ➔ P. XXXX	Cleanroom Wash & Packaging ➔ P. XXXX	Screw Length Adjustment ➔ P. XXXX	Vibration Resistant ➔ P. XXXX	Modification process for captive use ➔ P. XXXX
1 piece in 1 pack	Cleanroom washed and packed	Not Available	Not Available	Not Available