

NSCS Set Collars - with Installation Hole - Clamping Type

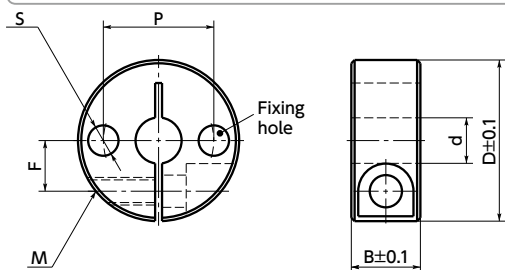

SUS Stainless steel



● Material/Finish



	NSCS-CP2	NSCS-MP2	NSCS-SP2
Main body	S45C Ferrosferic Oxide Film (Black)	S45C Electroless Nickel Plating	SUS304
Hex Socket Head Cap Screw	SCM435 Ferrosferic Oxide Film (Black)	SUSXM7	SUSXM7

- Set collar with installation hole. It can be installed to any machine and device such as wheels, flanges and plates, by using the fixing hole.
- Clamping Type. Mounting and removing are easy. Moreover this does not scratch the shaft.
- Optimal for machines and devices that are frequently mounted/removed, e.g. slide shaft.

NSCS-CP2 Made of Steel, Ferrosferic Oxide Film **NSCS-MP2** Made of Steel, Electroless Nickel Plating

NSCS-SP2 Made of Stainless Steel

Unit : mm

Part Number	Part Number	Part Number	d	B	D	F	S	P	M*1 (Coarse)	Mass (g)
NSCS-6-8-CP2	NSCS-6-8-MP2	NSCS-6-8-SP2	6	8	20	6	3.5	13	M3	15
NSCS-6-10-CP2	NSCS-6-10-MP2	NSCS-6-10-SP2	6	10	20	6	3.5	13	M4	19
NSCS-8-8-CP2	NSCS-8-8-MP2	NSCS-8-8-SP2	8	8	25	8	4.5	16	M3	23
NSCS-8-10-CP2	NSCS-8-10-MP2	NSCS-8-10-SP2	8	10	25	8	4.5	18	M4	29
NSCS-8-12-CP2	NSCS-8-12-MP2	NSCS-8-12-SP2	8	12	28	8.5	5.5	18	M5	44
NSCS-8-15-CP2	NSCS-8-15-MP2	NSCS-8-15-SP2	8	15	30	9.5	5.5	20	M6	63
NSCS-10-10-CP2	NSCS-10-10-MP2	NSCS-10-10-SP2	10	10	30	9	5.5	20	M4	41
NSCS-10-12-CP2	NSCS-10-12-MP2	NSCS-10-12-SP2	10	12	30	9	5.5	20	M5	49
NSCS-10-15-CP2	NSCS-10-15-MP2	NSCS-10-15-SP2	10	15	35	11	6.6	24	M6	84
NSCS-12-10-CP2	NSCS-12-10-MP2	NSCS-12-10-SP2	12	10	30	10	5.5	22	M4	38
NSCS-12-12-CP2	NSCS-12-12-MP2	NSCS-12-12-SP2	12	12	30	10	5.5	22	M5	47
NSCS-12-15-CP2	NSCS-12-15-MP2	NSCS-12-15-SP2	12	15	35	11	6.6	24	M6	82
NSCS-13-10-CP2	NSCS-13-10-MP2	NSCS-13-10-SP2	13	10	30	10	4.5	22	M4	38
NSCS-13-15-CP2	NSCS-13-15-MP2	NSCS-13-15-SP2	13	15	35	11	6.6	24	M6	81
NSCS-15-10-CP2	NSCS-15-10-MP2	NSCS-15-10-SP2	15	10	32	11	4.5	24	M4	43
NSCS-15-12-CP2	NSCS-15-12-MP2	NSCS-15-12-SP2	15	12	35	12	5.5	26	M5	64
NSCS-15-15-CP2	NSCS-15-15-MP2	NSCS-15-15-SP2	15	15	40	13	6.6	28	M6	109
NSCS-16-10-CP2	NSCS-16-10-MP2	NSCS-16-10-SP2	16	10	35	12	4.5	25	M4	52
NSCS-16-12-CP2	NSCS-16-12-MP2	NSCS-16-12-SP2	16	12	35	12	5.5	26	M5	61
NSCS-16-15-CP2	NSCS-16-15-MP2	NSCS-16-15-SP2	16	15	40	13	6.6	28	M6	105
NSCS-20-10-CP2	NSCS-20-10-MP2	NSCS-20-10-SP2	20	10	40	14	5.5	30	M4	64
NSCS-20-12-CP2	NSCS-20-12-MP2	NSCS-20-12-SP2	20	12	40	14	5.5	30	M5	77
NSCS-20-15-CP2	NSCS-20-15-MP2	NSCS-20-15-SP2	20	15	45	15	6.6	34	M6	130
NSCS-25-12-CP2	NSCS-25-12-MP2	NSCS-25-12-SP2	25	12	45	17	5.5	36	M5	91
NSCS-25-15-CP2	NSCS-25-15-MP2	NSCS-25-15-SP2	25	15	50	18	6.6	38	M6	152
NSCS-30-15-CP2	NSCS-30-15-MP2	NSCS-30-15-SP2	30	15	55	20	6.6	44	M6	174
NSCS-35-15-CP2	NSCS-35-15-MP2	NSCS-35-15-SP2	35	15	60	23	6.6	48	M6	196
NSCS-40-18-CP2	NSCS-40-18-MP2	NSCS-40-18-SP2	40	18	70	26	9	56	M8	328
NSCS-50-22-CP2	NSCS-50-22-MP2	NSCS-50-22-SP2	50	22	85	32	11	68	M10	572

*1: Hex socket head cap screw is provided.

● Part number specification

NSCS-10-10-CP2



Cleanroom Wash & Packaging → P.0000	Screw Length Adjustment → P.0000	Vibration Resistant → P.0000	Laser Marking → P.0000
Please feel free to contact us	Not Available	Not Available	Available / Add'l charge