

MRG/MRGS Rigid Couplings - Set Screw Type

[WEB Selection Tool](#)
[WEB CAD Download](#)
[Zero Backlash](#)
[High torque](#)
[High Rigidity](#)
[SUS Stainless steel](#)

MRG Made of aluminum alloy
MRGS Made of all stainless steel

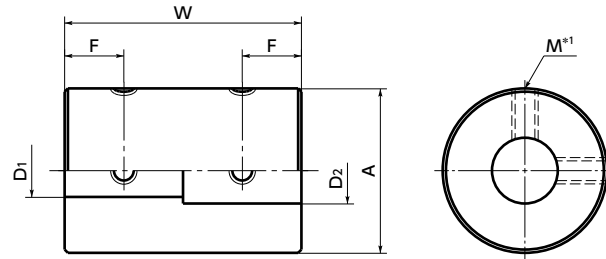

*1: In a case where the bore diameter is $\phi 4$ or less, the set screw is used in only one place.

Dimensions • Performance

Unit : mm

Part Number ¹	A	W	F	M	Screw Tightening Torque (N·m)	Standard Bore Diameter (Dimensional Allowance H8)																
						D1/D2 ²																
						3	4	5	6	8	10	12	15	16	18	19	20	25	28	30	32	
MRG-16	16	24	6	M3	0.7	●	●	●	●													
MRG-20	20	30	7	M3	0.7				●	●	●											
MRG-25	25	36	9	M4	1.7					●	●	●										
MRG-32	32	41	10	M4	1.7							●	●	●								
MRG-40	40	44	10.5	M5	4								●	●	●	●	●					
MRG-50	50	53	12	M6	7											●	●	●				
MRG-65	65	65	16	M8	15														●	●	●	
MRGS-16	16	24	6	M3	0.7			●	●													
MRGS-20	20	30	7	M3	0.7				●	●	●											
MRGS-25	25	36	9	M4	1.7					●	●	●										
MRGS-32	32	41	10	M4	1.7							●	●	●								
MRGS-40	40	44	10.5	M5	4								●	●	●	●	●					
MRGS-50	50	53	12	M6	7											●	●	●				
MRGS-65	65	65	16	M8	15															●	●	●

- All products are provided with hex socket set screws.
- Recommended tolerance for shaft diameters is h6 and h7.

Performance

Part Number	Max. Bore Diameter (mm)	Rated Torque *1 (N·m)	Max. Rotational Frequency (min ⁻¹)	Moment of Inertia *2 (kg·m ²)	Mass *2 (g)
MRG-16	8	1	39000	4.4×10 ⁻⁷	11
MRG-20	10	2.5	31000	1.3×10 ⁻⁶	20
MRG-25	12	4.5	25000	3.9×10 ⁻⁶	39
MRG-32	16	10	19000	1.2×10 ⁻⁵	71
MRG-40	20	20	15000	2.8×10 ⁻⁵	114
MRG-50	25	25	12000	8.4×10 ⁻⁵	215
MRG-65	32	35	9000	2.9×10 ⁻⁴	450
MRGS-16	8	0.3	39000	1.2×10 ⁻⁶	28
MRGS-20	10	0.5	31000	3.5×10 ⁻⁶	54
MRGS-25	12	1	25000	1.0×10 ⁻⁵	100
MRGS-32	16	2	19000	3.1×10 ⁻⁵	190
MRGS-40	20	3	15000	8.1×10 ⁻⁵	326
MRGS-50	25	4.5	12000	2.4×10 ⁻⁴	658
MRGS-65	32	7	9000	8.4×10 ⁻⁴	1290

- *1: Correction of rated torque due to load fluctuation is not required.
- *2: These are values with max. bore diameter.

• Part number specification

MRGS-40 - 18-20



[Additional Keyway at Shaft Hole → P. xxx](#)
[Cleanroom Wash & Packaging → P. xxx](#)
[Change to Stainless Steel Screw → P. xxx](#)

Available / Add'l charge Please feel free to contact us Please feel free to contact us