

SPV-C Plastic Screw - Hex Socket Head Cap Screws - PVDF

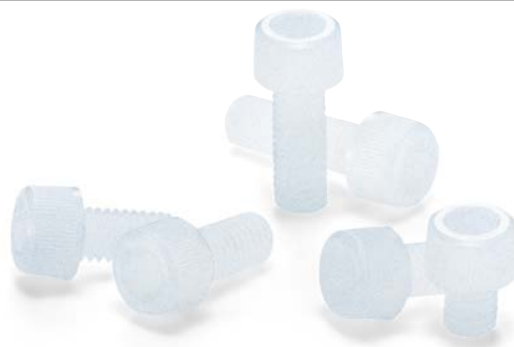

Chemical-proof

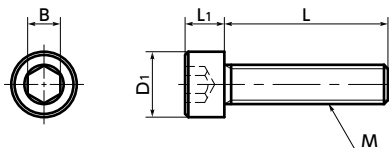

● Application

FPD production equipment / Semiconductor devices / Printed circuit board etching devices / Metallic surface treatment equipment and facilities / Chemical plants / Food industry machines

● Material/Finish



SPV-C	
Main body	PVDF (Polyvinylidene Fluoride) (Milky White)
Heat resistance temperature*1	150°C

*1: This is the value for the plastic material. The maximum operating temperature of the product changes with performance conditions such as tightening torque.

- PVDF has excellent chemical resistance against strong acids and organic solvents as well as halogen compounds such as hydrogen sulfide and bromine.
- It can be used in atmospheres in which metal and PVC (polyvinyl chloride) cannot be used.
- Max. Operating Temperature*1 (min./max.): -40/150°C
- Its tensile strength equals or exceeds that of PVC, and its impact strength is 3 times that of PVC.
- It is self-extinguishing and has excellent incombustibility.
- The properties and precautions of plastic screws
➔ P.xxxx

Unit : mm

Part Number	M (Coarse)		L	D1	L1	B	Tension*1 Rupture Load (N)	Torsional*1 Torque (N·m)	Mass (g)	Qty per pack
	Nominal of Thread	Pitch								
SPV-M3-C	M3	0.5	5 6 8	5.5	3	2.5	227	0.11	0.15 - 0.23	20
SPV-M4-C	M4	0.7	5 6 8	7	4	3	429	0.26	0.33 - 0.61	20
SPV-M5-C	M5	0.8	10 12 15 20 25 30 35	8.5	5	4	688	0.44	0.62 - 1.5	20
SPV-M6-C	M6	1	10 12 15 20 25 30 35 40	10	6	5	960	0.81	1.1 - 2.6	10
SPV-M8-C	M8	1.25	10 12 15 20 25 30 35 40	13	8	6	1803	1.56	2.4 - 4.8	10
SPV-M10-C	M10	1.5	15 20 25 30 35 40	16	10	8	2824	3.16	4.7 - 7.6	10
SPV-M12-C	M12	1.75	20 25 30 35 40 18	18	12	10	4249	5.73	7.4 - 11	10

*1: Values in chart are for reference only. They are not guaranteed values. The recommendation torque is 50% of the torsional torque.
● When purchasing less volume than one full bag, a separate handling fee is charged. For details, see the Sold Separately Service.

● Part number specification

SPV - M5 - 15 - C



Individual Sales ➔ P.xxxx	Cleanroom Wash & Packaging ➔ P.xxxx	Screw Length Adjustment ➔ P.xxxx	Vibration Resistant ➔ P.xxxx	Modification process for captive use ➔ P.xxxx
Available / Add'l charge	Available / Add'l charge	Available / Add'l charge	Not Available	Please feel free to contact us