

# SPC-C Plastic Screws - Hex Socket Head Cap Screws - PC

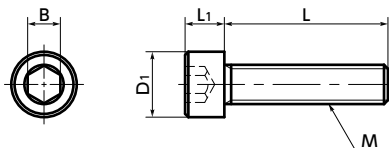

● Material/Finish



	<b>SPC-C</b>
Main Body	PC (Polycarbonate) (Transparent)
Heat Resistance Temperature*1	115°C

\*1: This is the value for the resin material. The operating temperature of the product changes with performance conditions such as tightening torque.

- PC (polycarbonate) has the highest shock resistance of engineering plastics.
- Max. Operating Temperature\*1(min./max.): -40/115°C
- PC has low water absorbency and excellent weather resistance.
- The properties and precautions of plastic screws  
→ P.xxxx

● Application

Electrical and electronic equipment and automobiles

Part Number	M (Coarse)		L												D1	L1	B	Tension Rupture Load*1 (N)	Torsional Torque*1 (N·m)	Mass (g)	Qty per Pack				
	Nominal of Thread	Pitch	6	8	10	12	15	20	25																
<b>SPC-M3-C</b>	M3	0.5	6	8	10	12	15	20	25										5.5	3	2.5	266	0.18	0.11 - 0.25	20
<b>SPC-M4-C</b>	M4	0.7	6	8	10	12	15	20	25										7	4	3	481	0.39	0.23 - 0.48	20
<b>SPC-M5-C</b>	M5	0.8			10	12	15	20	25	30	35								8.5	5	4	797	0.8	0.42 - 0.97	20
<b>SPC-M6-C</b>	M6	1			10		15	20	25	30	35	40							10	6	5	1136	1.2	0.72 - 1.7	20
<b>SPC-M8-C</b>	M8	1.25			10		15	20	25	30	35	40	13	8	6				13	8	6	2088	3.2	1.6 - 3.3	20

Unit : mm

\*1: Values in chart are for reference only. They are not guaranteed values. The recommended tightening torque is 50% of the torsional torque.

● When purchasing less volume than one full bag, a separate handling fee is charged. For details, see the Sold Separately Service.

● Part number specification

## SPC-M5-20-C

Product Code	1	2	Product Code
--------------	---	---	--------------

Individual Sales → P.xxxx	Cleanroom Wash & Packaging → P.xxxx	Screw Length Adjustment → P.xxxx	Vibration Resistant → P.xxxx	Modification process for captive use → P.xxxx
Available / Add'l charge	Available / Add'l charge	Available / Add'l charge	Not Available	Please feel free to contact us