

**SSHH-C22**

Hex Socket Head Cap Screws with Special Low Profile (Hastelloy C - 22 equiv.)

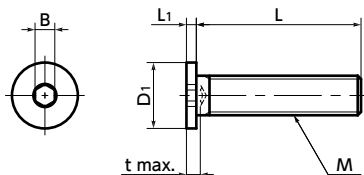

Protrusion
 Cleanroom wash &amp; packaging
 Chemical-proof



- Engraved on the top of the head to distinguish it from other materials

- Material/Finish



	<b>SSHH-C22</b>
Main Body	UNS N06022 (Hastelloy*1 C-22 equiv.)

\*1: Hastelloy is a registered trademark of Haynes International, Inc.

- Mechanical Properties

	Hastelloy (UNS N06022)	SUS304
Tensile Strength (N/mm <sup>2</sup> )	690 or More	520 or More
0.2% Proof Load (N/mm <sup>2</sup> )	310 or More	205 or More
Elongation (%)	45 or More	40 or More

- Values in chart are for reference only. They are not guaranteed values.

- Physical Properties

	Hastelloy (UNS N06022)	SUS304
Specific Gravity	8.69	7.93
Longitudinal Elastic Modulus (GPa)	206	193
Specific Heat (J/kg·K)	414	500
Electric Resistance ( $\mu\Omega \cdot m$ )	1.14	0.7
Linear Expansion Coefficient (K <sup>-1</sup> )	$12.4 \times 10^{-6}$	$17.3 \times 10^{-6}$

- Values in chart are for reference only. They are not guaranteed values.



- Hex Socket Head Cap Screws with Special Low Profile equivalent to Hastelloy C-22.
- All head heights are 1.5 mm or less. For space-saving of equipment/devices and applications with limited overhead space.
- Hastelloy C-22 is one of the few metals which can withstand wet chlorine gas, hypochlorite, and chlorine dioxide.
- Excellent corrosion resistance against oxidizing and reducing acids and salts.
- For Offshore instrument that handles seawater and salt water.
- Cleanroom wash/cleanroom packing provided.

- Application

Reducing the size of equipment and devices  
 FPD production equipment / Semiconductor manufacturing equipment /  
 Printed circuit board etching devices /  
 Metallic surface treatment equipment and facilities / Chemical plants

Unit : mm

Part Number	M (Coarse)		L										D1	L1	B	t max.	Max. Torque (N·m)	Mass (g)	
	Nominal of Thread	Pitch	4	5	6	8	10	12											
<b>SSHH-M2-C22</b>	M2	0.4	4	5	6	8	10	12						4	1.1	1.3	1.2	0.12	0.17 - 0.31
<b>SSHH-M2.5-C22</b>	M2.5	0.45	4	5	6	8	10	12						5	1.3	1.3	1.5	0.5	0.32 - 0.55
<b>SSHH-M3-C22</b>	M3	0.5	4	5	6	8	10	12						6	1.3	1.5	2	0.8	0.46 - 0.8
<b>SSHH-M4-C22</b>	M4	0.7		5	6	8	10	12	16					8	1.5	2	2.5	1.9	0.92 - 1.8
<b>SSHH-M5-C22</b>	M5	0.8			6	8	10	12	16	20	25			9	1.5	3	3	3.6	1.4 - 3.8

- Part Number Specification

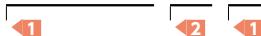
**SSHH-M5-12-C22**

Batch cleanroom packing is provided for orders containing multiple items of the same size.

Individual Sales	Cleanroom Wash & Packaging	Screw Length Adjustment	Vibration Resistant	Modification process for captive use
1 piece in 1 pack	Cleanroom washed and packed	Available / Add'l charge	Available / Add'l charge	Not Available