

SLHL Hex Socket Head Cap Screws with Low Profile (SUS316L)

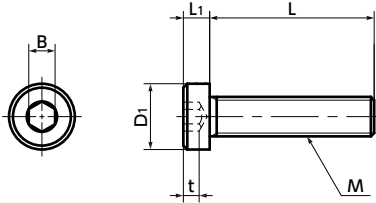

Protrusion SUS Stainless steel



• To distinguish from **SLHS**, following processing are made.

- SLHL-M3** Cup-pointed at screw tips or
- SLHL-M4** Convex mark processing on top of heads



- SLHL-M5** Indicated as "A4" on the top
- SLHL-M6** of screw heads



- Socket head cap screws with low profile made of SUS316L.
- Intended for reducing the size of devices and applications with limited overhead space.
- Compared to SUS304, SUS316L has excellent hydrogen embrittlement resistance, fluorine and chlorine gas resistance, and heat resistance. This screw also has corrosion resistance against chemical products and seawater environments that matches or exceeds SUS304.
- SUS316L is non-magnetic.
- Conforms to DIN 7984.

Application

Reducing the size of equipment and devices
 FPD production equipment/Semiconductor devices/
 Aquatic applications/General industrial machines

Material/Finish



| | SLHL |
|----------------|---------|
| Main Body | SUS316L |
| Strength Class | A4-70 |

- Do not exceed the max. tightening torque.

SLHL SUS316L

Unit : mm

| Part Number | M (Coarse) | | L | | | | | | | D1 | L1 | B | t | Max. Torque (N·m) | Mass (g) | Qty per Pack |
|----------------|-------------------|-------|---|---|----|----|----|----|--|-----|-----|-----|-----|-------------------|------------|--------------|
| | Nominal of Thread | Pitch | 6 | 8 | 10 | 12 | 16 | 20 | | | | | | | | |
| SLHL-M3 | M3 | 0.5 | 6 | 8 | 10 | | | | | 5.5 | 2 | 2 | 1.5 | 1.2 | 0.53 - 0.7 | 20 |
| SLHL-M4 | M4 | 0.7 | 6 | 8 | 10 | 12 | | | | 7 | 2.8 | 2.5 | 2.3 | 3.2 | 1.1 - 1.6 | 20 |
| SLHL-M5 | M5 | 0.8 | | 8 | 10 | 12 | 16 | | | 8.5 | 3.5 | 3 | 2.7 | 6.4 | 1.8 - 2.8 | 10 |
| SLHL-M6 | M6 | 1 | | | 10 | 12 | 16 | 20 | | 10 | 4 | 4 | 3 | 11 | 3.5 - 5.3 | 10 |

• When purchasing less volume than one full bag, a separate handling fee is charged. For details, see the Sold Separately Service.

Part number specification



| | | | | |
|---------------------------|-------------------------------------|----------------------------------|------------------------------|---|
| Individual Sales → P.0000 | Cleanroom Wash & Packaging → P.0000 | Screw Length Adjustment → P.0000 | Vibration Resistant → P.0000 | Modification process for captive use → P.0000 |
| Available / Add'l charge | Available / Add'l charge | Available / Add'l charge | Available / Add'l charge | Available / Add'l charge |