

# SCAP-PT/SNCPS Cover Caps - PTFE / Socket Head Cap Screws for Cover Caps

WEB Selection Tool | WEB CAD Download | SUS Stainless steel | Cleanroom wash & packaging | Chemical-proof

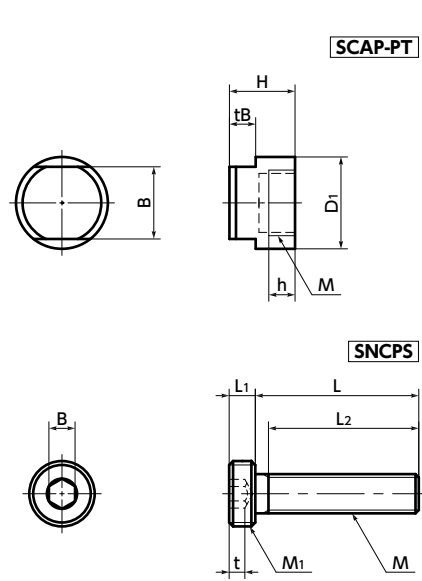

- Combine **SCAP-PT** Cover Caps and **SNCPS** Socket Head Cap Screws for Cover Caps.
- The PTFE (Polytetrafluoroethylene) cover protects the screw head from corrosion caused by chemicals.
- PTFE is a plastic with excellent chemical resistance, and most chemicals cannot penetrate it.
- Chemical Resistance of PTFE → P.xxxx
- Since the screw portion is stainless steel, they can be used with higher tightening forces than PTFE screws.
- Tightening with the recommendation torque has a sealing effect and the bearing surface of the cover cap fits the attachment surface tightly. Airtight testing at 0.6 MPa confirmed that there is no leakage.
- Also, make cover caps from requested materials such as Hastelloy\*1 and PEEK are available.
- \*1: Hastelloy is a registered trademark of Haynes International.
- Application**

FPD production equipment, semiconductor fabrication wet processes, printed circuit board etching devices, metallic surface treatment equipment and facilities, cleaning equipment, and chemical plants

**Material/Finish** RoHS2 Compliant

	SCAP-PT Cover Caps	SNCPS Socket Head Cap Screws
Main Body	PTFE (Polytetrafluoroethylene)	SUSXM7 (Equivalent to SUS304)
Strength Class		A2-50

## SCAP-PT Cover Caps

Part Number	M (Fine)		H	D1	h	B	tB	Recommendation Torque (N·m)	SNCPS Part.No	Mass (g)	Qty per pack
	Nominal of Thread	Pitch									
SCAP-3-PT	M5	0.5	6	9	2	7	3	0.04	SNCPS-M3	0.65	1
SCAP-4-PT	M6	0.75	8	10	2.8	8	3	0.08	SNCPS-M4	1.1	1
SCAP-5-PT	M8	0.75	9	12	3.5	9	3	0.2	SNCPS-M5	1.6	1
SCAP-6-PT	M10	0.75	10	14	4	11	4	0.35	SNCPS-M6	2.3	1
SCAP-8-PT	M12	1	11	16	5	13	4	0.45	SNCPS-M8	3.1	1
SCAP-10-PT	M16	1	12	20	6	17	4	0.6	SNCPS-M10	4.8	1

- Usage**  
After tightening **SNCPS** Socket Head Cap Screw for Cover Cap, attach **SCAP-PT** Cover Cap so that it covers the head of **SNCPS**.  
Ensure that the tightening torque of **SCAP-PT** does not exceed the recommendation torque in the chart.

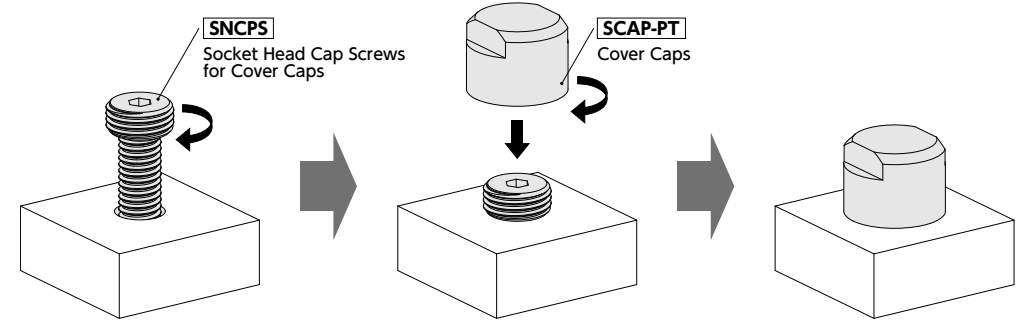

## Related Products

**SCAP-AL** aluminum alloy for use in vacuum chambers are available.  
→ P.xxxx



**SCAP-CE** ceramic cover cap for use in vacuum chambers are available.  
→ P.xxxx



## Part number specification

**SCAP-6-PT** **SCAP-PT** Cover Caps

1

**SNCPS-M6-20** **SNCPS** Socket Head Cap

2

3

Order **SCAP-PT** and **SNCPS** individually.

## SNCPS Socket Head Cap Screws for Cover Caps

Part Number	M (Coarse)		L							M1 (Fine)		L1	B	t	L2*1	SCAP-PT Part.No	Mass (g)		
	Nominal of Thread	Pitch	6	8	10	12	16	20	25	30	35							Nominal of Thread	Pitch
SNCPS-M3	M3	0.5	6	8	10	12						M3	0.5	2	2	1.5	Full Thread	SCAP-3	0.53 - 0.78
SNCPS-M4	M4	0.7	8	10	12	16						M4	0.7	2.8	2.5	2.3	Full Thread	SCAP-4	1.3 - 1.9
SNCPS-M5	M5	0.8			10	12	16	20				M5	0.8	3.5	3	2.7	Full Thread	SCAP-5	2 - 3.3
SNCPS-M6	M6	1				12	16	20	25			M6	1	4	4	3	Full Thread	SCAP-6	3.8 - 6.4
SNCPS-M8	M8	1.25					16	20	25	30		M8	1.25	5	5	3.8	Full Thread	SCAP-8	9 - 16
SNCPS-M8	M8	1.25								35		M8	1.25	5	5	3.8	22	SCAP-8	9 - 16
SNCPS-M10	M10	1.5						20	25	30	35	M10	1.5	6	6	4.5	Full Thread	SCAP-10	17 - 27
SNCPS-M10	M10	1.5									40	M10	1.5	6	6	4.5	26	SCAP-10	17 - 27

\*1: If the L value is other than the value in parentheses, the screw is full thread.

SNCPS-M3	1
SNCPS-M4	1
SNCPS-M5	1
SNCPS-M6	1
SNCPS-M8	1
SNCPS-M10	1

Individual Sales → P.xxxx | Cleanroom Wash & Packaging → P.xxxx | Screw Length Adjustment → P.xxxx | Vibration Resistant → P.xxxx | Modification process for captive use → P.xxxx  
1 pc. in 1 bag | Cleanroom washed and packed | S.S. only/ Add'l charge | Please feel free to contact us | Not Available