

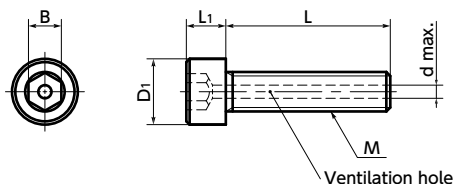

# SVSM Molybdenum Hex Socket Head Cap Screws with Ventilation Hole

Vacuum Cleanroom wash & packaging Heat-resistance



## Material/Finish



	SVSM
Main Body	Pure Molybdenum

## Mechanical property

	Pure Molybdenum	SUS304
Tensile Strength (N/mm <sup>2</sup> )	515	520 or More
0.2% Proof Load (N/mm <sup>2</sup> )	380	205 or More
Elongation (%)	15	40 or More

• Values in chart are for reference only. They are not guaranteed values.

## Physical property

	Pure Molybdenum	SUS304
Specific Gravity	10.2	7.93
Longitudinal Elastic Modulus (GPa)	327	193
Electric Resistance ( $\mu\Omega \cdot m$ )	0.058	0.7
Thermal Conductivity (W/(m·K))	142	17
Linear Expansion Coefficient (K <sup>-1</sup> )	$5.1 \times 10^{-6}$	$17.3 \times 10^{-6}$

• Values in chart are for reference only. They are not guaranteed values.

- Molybdenum hex socket head cap screws **SNSM** with ventilation hole.
- The ventilation hole easily releases gas trapped in the screw holes of equipment and machines, and supports vacuum drawing of vacuum devices.
- Melting point: 2623°C. Excellent heat resistance.
- Supports use with vacuum equipment in high-temperature environments.
- Cleanroom wash/cleanroom packing provided. ➔ P. xxxx

## Application

Vacuum devices / Vacuum chambers / FPD production equipment / Semiconductor manufacturing equipment / Electron microscopes / Sputtering equipment / High-temperature furnaces



## Precautions for Use

Note that in an oxidizing atmosphere, sublimation will begin at 600°C or higher.

Unit : mm

Part Number <b>1</b>	M (Coarse)		L <b>2</b>	D1	L1	B	d max.	Mass (g)								
	Nominal of Thread	Pitch														
<b>SVSM-M3</b>	M3	0.5	6	8	10	12	16	20			5.5	3	2.5	1.2	0.93 - 1.8	
<b>SVSM-M4</b>	M4	0.7		8	10	12	16	20	25		7	4	3	1.5	2.2 - 4.1	
<b>SVSM-M5</b>	M5	0.8			10	12	16	20	25		8.5	5	4	1.5	3.5 - 6.3	
<b>SVSM-M6</b>	M6	1				12	16	20	25	30	10	6	5	2	6.6 - 11	
<b>SVSM-M8</b>	M8	1.25					16	20	25	30	35	13	8	6	2	16 - 25

## Part number specification

### SVSM-M5-16

**1** **2**

Batch cleanroom packing is provided for orders containing multiple items of the same size.

<b>1</b> Individual Sales ➔ P. xxxx	<b>2</b> Cleanroom Wash & Packaging ➔ P. xxxx	<b>3</b> Screw Length Adjustment ➔ P. xxxx	<b>4</b> Vibration Resistant ➔ P. xxxx	<b>5</b> Modification process for captive use ➔ P. xxxx
1 piece in 1 pack	Cleanroom washed and packed	Available / Add'l charge	Not Available	Please feel free to contact us