

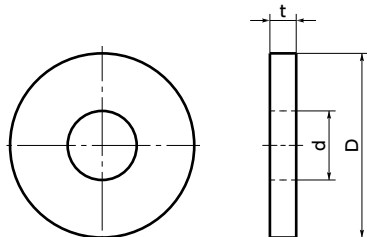

SWF High Intensity Flat Washers

High strength

Vibration resistant treatment



- Flat washers for high intensity screws.
- The surface area is twice or more of that of standard washers. Washers eliminate bolt looseness by preventing the sinking of the bearing surface.
- For the connection of materials with low limits for bearing surface pressure such as aluminum and plastic.

● Application

Prevention of bearing surface sinking and loosening

● Material/Finish



	SWF
Main Body	SCM435 (Hardness 350 - 430 HV) Ferrosoferric Oxide Coating (Black)

Unit : mm

Part Number	Nominal	d	D	t	Mass (g)
SWF-6	6	6.4 ^{+0.3} ₀	17 ⁰ _{-0.43}	3	5
SWF-8	8	8.4 ^{+0.3} ₀	23 ⁰ _{-0.52}	4	11
SWF-10	10	10.5 ^{+0.3} ₀	28 ⁰ _{-0.52}	4	17
SWF-12	12	13 ^{+0.4} ₀	35 ⁰ _{-0.52}	5	33
SWF-16	16	17 ^{+0.4} ₀	45 ⁰ _{-0.62}	6	64

● Part number specification

SWF-8



Individual Sales → P.0000	Cleanroom Wash & Packaging → P.0000	Screw Length Adjustment → P.0000	Vibration Resistant → P.0000	Modification process for captive use → P.0000
1 piece in 1 pack	Not Available	Not Available	Not Available	Not Available