

# TAS-1 Miniature X-axis Block Stages

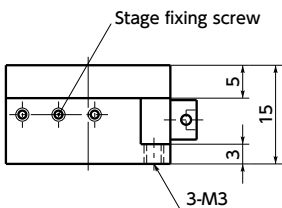

WEB Selection Tool    WEB CAD Download

## TAS-251

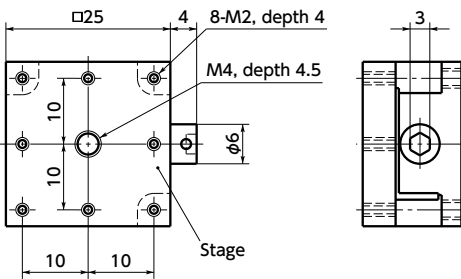

## TAS-401

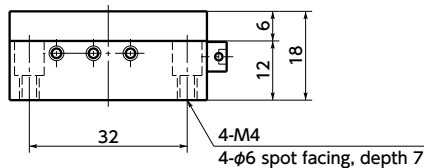
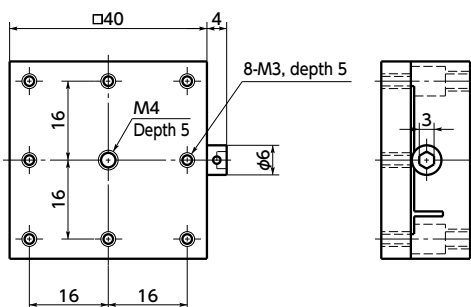

## TAS-401



## TAS-251

- A stage to move by a hexagon wrench.
- Screws are used for micromotion feed.
- Dovetail groove method is adopted for the travel guide. A rattle correction function is provided.
- New design with low stage height. Effective when there is space constraints or for assembly.

### Material/Finish



	TAS
Main body	Brass Black chrome plating

- Mounting  
Spot facing is performed on the screw hole for mounting. Therefore, fixing from vertical directions is possible.

### Fixing from above

**TAS-251** ——— M2

**TAS-401** ——— M3

### Fixing from beneath

**TAS-251** ——— M3

**TAS-401** ——— M4

### Part number specification

## TAS-251



Part Number	Stage Face	Travel Guide	Travel distance	Screw Pitch	Mass (g)
<b>TAS-251</b>	25×25	Dovetail Groove Method	±3	0.5	60
<b>TAS-401</b>	40×40	Dovetail Groove Method	±7	0.5	200

Unit : mm

Part Number	Straightness	Parallelism	Position Resolution	Withstand load (N)
<b>TAS-251</b>	0.01	0.05	0.01	49
<b>TAS-401</b>	0.01	0.05	0.01	98.1

Unit : mm

- Hexagon wrench for stage operations, hexagonal wrench with a knob and pan head machine screws for mounting (M2 × 6 **TAS-251** and M3 × 8 **TAS-401**) are provided.