

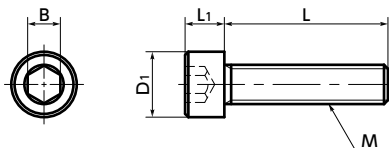

SNSH-C276 Hex Socket Head Cap Screws (Hastelloy C - 276 equiv.)

Cleanroom wash & packaging Chemical-proof



● Mechanical property

	Hastelloy (UNS N10276)	SUS304
Tensile Strength (N/mm ²)	690 or More	520 or More
0.2% Proof Stress (N/mm ²)	283 or More	205 or More
Elongation (%)	40 or More	40 or More

● Values in chart are for reference only. They are not guaranteed values.

● Physical property

	Hastelloy (UNS N10276)	SUS304
Specific Gravity	8.89	7.93
Longitudinal Elastic Modulus (GPa)	205	193
Specific Heat (J/kg·K)	427	500
Electric Resistance (μΩ·m)	1.23	0.7
Linear Expansion Coefficient (K ⁻¹)	11.2×10 ⁻⁶	17.3×10 ⁻⁶

● Values in chart are for reference only. They are not guaranteed values.



- Hastelloy C-276 is a general type of Hastelloy.
- Excellent corrosion resistance against oxidizing and reducing salts.
- Cleanroom wash and cleanroom packing are completed.
- Also, **[SNSH-C22]** Socket Head Screw-Hastelloy (Hastelloy C-22), which is also resistant to wet chlorine gas, hypochlorite, and chlorine dioxide is available.
- Equivalent to JIS B 1176, ISO 4762, and DIN 912.

● Application

FPD production equipment, semiconductor devices, printed circuit board etching devices, metallic surface treatment equipment and facilities, and chemical plants

● Material/Finish



SNSH-C276	
Main Body	UNS N10276(Hastelloy*1C-276 equiv.)

*1 : Hastelloy is a registered trademark of Haynes International, Inc.

Unit : mm

Part Number	M (Coarse)		L										D1	L1	B	Tension*1 Rupture Load (N)	Mass (g)	
	Nominal of Thread	Pitch																
SNSH-M3-C276	M3	0.5	6	8	10	12	16	20						5.5	3	2.5	3980	0.81 - 1.6
SNSH-M4-C276	M4	0.7		8	10	12	16	20	25					7	4	3	6960	1.9 - 3.6
SNSH-M5-C276	M5	0.8			10	12	16	20	25					8.5	5	4	11200	3.1 - 5.4
SNSH-M6-C276	M6	1				12	16	20	25	30				10	6	5	15900	5.8 - 9.5
SNSH-M8-C276	M8	1.25					16	20	25	30	35			13	8	6	29000	14 - 22

*1 : Values in chart are for reference only. They are not guaranteed values.

● Part number specification

SNSH - M5 - 16 - C276

Product Code Product Code

Batch cleanroom packing is provided for orders containing multiple items of the same size.

Individual Sales	Cleanroom Wash & Packaging	Screw Length Adjustment	Vibration Resistant	Modification process for captive use
1 piece in 1 pack	Cleanroom washed and packed	Available / Add'l charge	Available / Add'l charge	Available / Add'l charge