

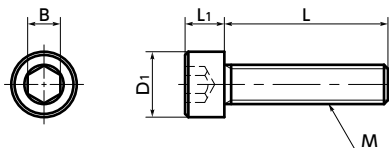

SNSH-C22 Socket Head Cap Screws - Hastelloy C - 22 equiv.

Cleanroom wash & packaging Chemical-proof



● Material/Finish



	SNSH-C22
Main Body	UNS N06022 (Hastelloy* ¹ C-22 equiv.)

*1: Hastelloy is a registered trademark of Haynes International, Inc.

● Mechanical Properties

	Hastelloy (UNS N06022)	SUS304
Tensile Strength (N/mm ²)	690 or Higher	520 or Higher
0.2% Proof Load (N/mm ²)	310 or Higher	205 or Higher
Elongation (%)	45 or Higher	40 or Higher

● Values in chart are for reference only. They are not guaranteed values.

● Physical Properties

	Hastelloy (UNS N06022)	SUS304
Specific Gravity	8.69	7.93
Longitudinal Elastic Modulus (GPa)	206	193
Specific Heat (J/kg·K)	414	500
Electric Resistance (μΩ·m)	1.14	0.7
Linear Expansion Coefficient (K ⁻¹)	12.4 × 10 ⁻⁶	17.3 × 10 ⁻⁶

● Values in chart are for reference only. They are not guaranteed values.

- Hastelloy C-22 is one of the few metals that is resistant to wet chlorine gas, hypochlorite, and chlorine dioxide.
- Excellent corrosion resistance against oxidizing and reducing acids and salts.
- For aquatic applications that use sea and salt water.
- Cleanroom wash and cleanroom packing are completed.
- Equivalent to JIS B 1176, ISO 4762, and DIN 912.
- Application

FPD production equipment, semiconductor devices, printed circuit board etching devices, metallic surface treatment equipment and facilities, and chemical plants

Unit : mm

Part Number	M (Coarse)		L	D1	L1	B	Tensile Breaking Load *1 (N)	Mass (g)
	Nominal of Thread	Pitch						
SNSH-M3-C22	M3	0.5	6 8 10 12	5.5	3	2.5	3950	0.79 - 1.5
SNSH-M4-C22	M4	0.7	8 10 12	7	4	3	6900	1.8 - 3.5
SNSH-M5-C22	M5	0.8	8 10 12 14	8.5	5	4	11100	2.7 - 5.3
SNSH-M6-C22	M6	1	12	10	6	5	15700	5.6 - 9.2
SNSH-M8-C22	M8	1.25	16 20 25 30	13	8	6	28700	13 - 21

*1: Values in chart are for reference only. They are not guaranteed values.

● Part Number Specification

SNSH-M5-16-C22

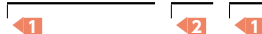

Batch cleanroom packing is provided for orders containing multiple items of the same size.

Individual Sales	Cleanroom Wash & Packaging	Screw Length Adjustment	Vibration Resistant	Modification process for captive use
1 piece in 1 pack	Cleanroom washed and packed	Available / Add'l charge	Available / Add'l charge	Available / Add'l charge