



Bore Additional Modification **[BT]**

- Coupling bores can be additionally modified. Bore diameters can be specified in 0.001 mm increments.
- For bore diameters D₁ and D₂, specify the standard bore diameter for each product from minimum diameter to maximum diameter.*1

*1: For standard and maximum bore diameters, see each product page.

For disk type, the bore diameters listed in the "Disk Type Bore Diameters Available" below can be specified with this service.

For bore diameters outside the range, please contact our customer service.

- Combination with the keyway additional modification **[KT]** *2 is also possible.

*2: The bore diameters listed in the "Keyway Additional Modification Applicable Bore Diameter List" are available for the service.

- Additional modification is also available for inch size bores. For inch size bore diameters, refer to the table below and specify in millimeter increments.

inch	mm	inch	mm
1/8	3.175	13/16	20.638
3/16	4.763	7/8	22.225
1/4	6.35	15/16	23.813
5/16	7.938	1	25.4
3/8	9.525	1 - 1/8	28.575
7/16	11.113	1 - 1/4	31.75
1/2	12.7	1 - 3/8	34.925
9/16	14.288	1 - 1/2	38.1
5/8	15.875	1 - 5/8	41.275
11/16	17.463	1 - 3/4	44.45
3/4	19.05	2	50.8

- When converting values into millimeters, round up the 4th digit after the decimal point.

Please note.

- For disk type bore diameters, specify from the available bore diameter range in the table below.

Unit: mm

Disk Type Bore Diameters Available									
D ₁ /D ₂									
3	4	4.5	5	6	6.35	7	8	9	
9.525	10	11	12	13	14	15	16	17	
18	19	20	22	24	25	28	30	32	
35	38	40	42	45	50				

- For bore diameters D₁ and D₂, specify the standard bore diameter for each product from minimum diameter to maximum diameter.

- Disk type specifiable bore diameters are regularly added. Please visit the NBK website for the latest information.

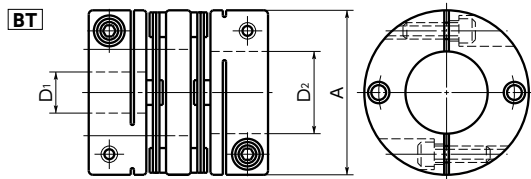

Target Products/Fees

- Coupling category products are targeted.
- Target products are displayed with [compatibility and fees](#) at the bottom of the product page.



Type	Product Code					
High-Gain Rubber	XGT2	XGL2	XGS2	XGT	XGL	XGS
Vibration-Absorption Capable*1	XGHW					
Disk*2	XHW	XHW-AC*3	XHS	XBW	XBS	MDW
	MDS	MHW	MHS			
	XBWS					
	XBSS					
Slit	MSX	MST	MWS	MSH		
	MSTS					
	MWSS					
Jaw	MJC	MJS				
Cross Joint	XUT					
Oldham	MOR	MOL	MOS	MOP		
	MOM					
	MOHS					
Bellows	MFB					
	MFBS					
Serration	MSF					
Rigid*4	MRG	MLR				
	MRGS	MLRS				

- Please contact our customer service for the price and delivery time of **[MJB]**, **[L]**, **[SS]**, **[LS]**, **[LSS]**, **[MKM]**, **[MWBS]**, **[XSTS]**, **[XWSS]**, **[MSXP]**, and **[XRP]**.

*1: Bore additional modification is only performed on the D₁ side for The vibration-absorption capable disk type **[XGHW]**

*2: For disk type bore diameters D₁ and D₂, specify from the disk type available bore diameter range table.

*3: Bore additional modification is only performed on the D₂ side for **[XHW-AC]**.

*4 **[MRG-W]**, **[MRGS-W]**, **[MLR-V]**, and **[MLRS-V]** are not available.

Delivery time

- Please contact our customer service.
- Please contact our customer service regarding combination with other services.

*1: Please contact our customer service for the delivery time of **[XUT]**, **[MOP]**, **[MOHS]** and **[MSH]**.

Part Number Specification

Additional modification of single-side bores

XHW-25C-7-BT-8

Coupling Part Number D₁ Modification Symbol D₂

Additional modification of double-side bores

XGT2-25C-7-BT-9.525-BT

Coupling Part Number D₁ Modification Symbol D₂ (Inch Thread) Modification Symbol

Additional modification of double-side bores + double-side keyways

MOL-50C-17-BT-KT-19-BT-KT

Coupling Part Number D₁ Modification Symbol D₂ Modification Symbol

Specify the modification symbol **[BT]** after the bore diameter to be modified.

Combination with the keyway additional modification **[KT]** *1 is also possible.

*1: The bore diameters listed in the "Keyway Additional Modification Applicable Bore Diameter List" are available for the service.

Bore additional modification

Keyway Additional Modification **KT**

- Couplings can be additionally modified with new JIS keyways based on JIS B 1301.
- The bore diameters listed in the "Keyway Additional Modification Applicable Bore List" in the table below are available for the service.
- Keyways are modified in positions determined by our references.
- Keyway additional modification is available for both single-side only and double-side.
- ⚠ As high-gain rubber and rigid types have the same bore diameter on both sides, keyway modification is available for double-side only.
- Combination with the bore additional modification **BT** is also possible.

Keyway Additional Modification Applicable Bore Diameter List

Applicable Bore Diameter D1/D2	Keyway				Key b×h Nominal Dimension
	b Reference Dimensions	Allowance JS9	t Reference Dimensions	Allowance	
6 7	2	±0.0125	1.0	+0.1 0	2×2
8 9 10	3	±0.0125	1.4	+0.1 0	3×3
11 12	4	±0.0150	1.8	+0.1 0	4×4
13 14 15 16 17	5	±0.0150	2.3	+0.1 0	5×5
18 19 20 22	6	±0.0150	2.8	+0.1 0	6×6
24 25 28 30	8	±0.0180	3.3	+0.2 0	8×7
32 35 36 38	10	±0.0180	3.3	+0.2 0	10×8
40 42 44	12	±0.0215	3.3	+0.2 0	12×8
45 48 50	14	±0.0215	3.8	+0.2 0	14×9

- The service does not cover keyway additional modification for combinations with bore diameters not listed in the table. Please contact our customer service for details.

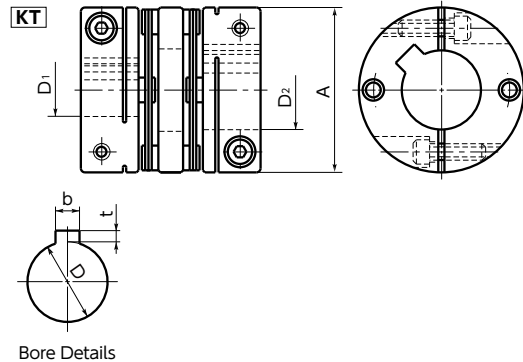

Target Products/Fees

- Coupling category products are targeted.
- Target products are displayed with **compatibility and fees** at the bottom of the product page.



Type	Product Code					
High-Gain Rubber	XGT2	XGL2	XGS2	XGT	XGL	XGS
Vibration-Absorption Capable*1	XGHW					
Disk	XHW	XHW-AC*2	XHS	XBW	XBS	MDW
	MDS	MHW	MHS			
Jaw	MJT					
Cross Joint	XUT					
Oldham	MOR	MOL	MOS	MOP		
	MOM					
Bellows	MOHS					
	MFBS					
Serration	MSF					
Rigid*3	MRG	MLR	MRGS	MLRS		

- Please contact our customer service for the price and delivery time of **MSX**, **MST**, **MSTS**, **MWS**, **MWSS**, **MKM**, **MWBS**, **XSTS**, and **XWSS**.
- We also offer keyway additional modification not listed in the catalog. Please contact our customer service.
- *1: Keyway additional modification is only performed on the D1 side for The vibration-absorption capable disk type **XGHW**
- *2: Keyway additional modification is only performed on the D2 side for **XHW-AC**.
- *3: Rigid Type **MRG-W** **MRGS-W** **MLR-V** **MLRS-V** is not targeted.

Delivery time

- Please contact our customer service.
- Please contact our customer service regarding combination with other services.
- *1: Please contact our customer service for the delivery time of **XUT**, **MOP**, and **MOHS**.

Part Number Specification

Additional modification of single-side keyway

XHW-25C-10-KT-12

Coupling Part Number D_1 Modification Symbol D_2

Additional modification of double-side keyways

XHW-25C-10-KT-12-KT

Coupling Part Number D_1 Modification Symbol D_2 Modification Symbol

Additional modification of double-side bore + keyway

MOL-50C-17-BT-KT-19-BT-KT

Coupling Part Number D_1 Modification Symbol D_2 Modification Symbol

Specify the modification symbol **KT** after the bore diameter with the keyway to be modified.
Combination with the bore additional modification **BT** is also possible.