

SCB-FB Clamping Bolts - Flat Ball - with Reversal Prevention Mechanism

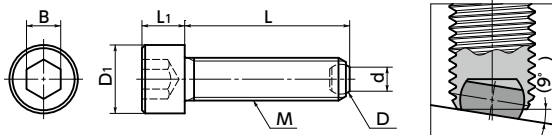

● Material/Finish



| | |
|-------------|--|
| | SCB-FB Made of Steel |
| Thread Part | SCM435 Ferrosoferric Oxide Film (Black) |
| Ball | SUJ2 (Hardness: 62 - 67 HRC) |

● Part Number Specification

SCB-M6-20-FB



- All sizes are standardized with full thread.
- The ball rotates flexibly . The reversal prevention mechanism always ensures secure clamping on the flat plane on the ball.
- We also produce products of special specifications, e.g. nominal diameter of thread, length and surface treatment. Please feel free to contact our customer service.

Unit : mm

| Part Number | M (Coarse) | | L | D1 | D | d (Reference Value) | L1 | B | Mass (g) |
|---------------|-------------------|-------|----|-----|------|---------------------|----|----|----------|
| | Nominal of Thread | Pitch | | | | | | | |
| SCB-M4-10-FB | M4 | 0.7 | 10 | 7 | 2.5 | 1.9 | 4 | 3 | 1.5 |
| SCB-M4-12-FB | M4 | 0.7 | 12 | 7 | 2.5 | 1.9 | 4 | 3 | 1.7 |
| SCB-M4-16-FB | M4 | 0.7 | 16 | 7 | 2.5 | 1.9 | 4 | 3 | 1.9 |
| SCB-M4-20-FB | M4 | 0.7 | 20 | 7 | 2.5 | 1.9 | 4 | 3 | 2.2 |
| SCB-M4-25-FB | M4 | 0.7 | 25 | 7 | 2.5 | 1.9 | 4 | 3 | 2.5 |
| SCB-M5-12-FB | M5 | 0.8 | 12 | 8.5 | 3 | 2.4 | 5 | 4 | 2.9 |
| SCB-M5-16-FB | M5 | 0.8 | 16 | 8.5 | 3 | 2.4 | 5 | 4 | 3.4 |
| SCB-M5-20-FB | M5 | 0.8 | 20 | 8.5 | 3 | 2.4 | 5 | 4 | 3.9 |
| SCB-M5-25-FB | M5 | 0.8 | 25 | 8.5 | 3 | 2.4 | 5 | 4 | 4.4 |
| SCB-M5-30-FB | M5 | 0.8 | 30 | 8.5 | 3 | 2.4 | 5 | 4 | 5 |
| SCB-M6-16-FB | M6 | 1 | 16 | 10 | 4 | 3.1 | 6 | 5 | 5.6 |
| SCB-M6-20-FB | M6 | 1 | 20 | 10 | 4 | 3.1 | 6 | 5 | 6.5 |
| SCB-M6-25-FB | M6 | 1 | 25 | 10 | 4 | 3.1 | 6 | 5 | 7.6 |
| SCB-M6-30-FB | M6 | 1 | 30 | 10 | 4 | 3.1 | 6 | 5 | 8.7 |
| SCB-M6-40-FB | M6 | 1 | 40 | 10 | 4 | 3.1 | 6 | 5 | 11 |
| SCB-M8-20-FB | M8 | 1.25 | 20 | 13 | 5.56 | 4.6 | 8 | 6 | 13.5 |
| SCB-M8-30-FB | M8 | 1.25 | 30 | 13 | 5.56 | 4.6 | 8 | 6 | 17.5 |
| SCB-M8-35-FB | M8 | 1.25 | 35 | 13 | 5.56 | 4.6 | 8 | 6 | 19 |
| SCB-M8-40-FB | M8 | 1.25 | 40 | 13 | 5.56 | 4.6 | 8 | 6 | 21.5 |
| SCB-M8-50-FB | M8 | 1.25 | 50 | 13 | 5.56 | 4.6 | 8 | 6 | 25 |
| SCB-M10-25-FB | M10 | 1.5 | 25 | 16 | 7.14 | 6.1 | 10 | 8 | 26 |
| SCB-M10-30-FB | M10 | 1.5 | 30 | 16 | 7.14 | 6.1 | 10 | 8 | 29 |
| SCB-M10-40-FB | M10 | 1.5 | 40 | 16 | 7.14 | 6.1 | 10 | 8 | 34 |
| SCB-M10-50-FB | M10 | 1.5 | 50 | 16 | 7.14 | 6.1 | 10 | 8 | 39 |
| SCB-M10-60-FB | M10 | 1.5 | 60 | 16 | 7.14 | 6.1 | 10 | 8 | 47 |
| SCB-M12-30-FB | M12 | 1.75 | 30 | 18 | 8.5 | 7.3 | 12 | 10 | 40 |
| SCB-M12-50-FB | M12 | 1.75 | 50 | 18 | 8.5 | 7.3 | 12 | 10 | 56 |
| SCB-M12-80-FB | M12 | 1.75 | 80 | 18 | 8.5 | 7.3 | 12 | 10 | 83 |
| SCB-M16-40-FB | M16 | 2 | 40 | 24 | 12 | 10.7 | 16 | 14 | 91 |
| SCB-M16-60-FB | M16 | 2 | 60 | 24 | 12 | 10.7 | 16 | 14 | 122 |
| SCB-M16-80-FB | M16 | 2 | 80 | 24 | 12 | 10.7 | 16 | 14 | 154 |

| | | | |
|--------------------------------|-------------------|-------------------------|--------------------------|
| Cleanroom Wash & Packaging | Screw Combination | Screw Length Adjustment | Vibration Resistant |
| Please feel free to contact us | Not Available | Not Available | Available / Add'l charge |