

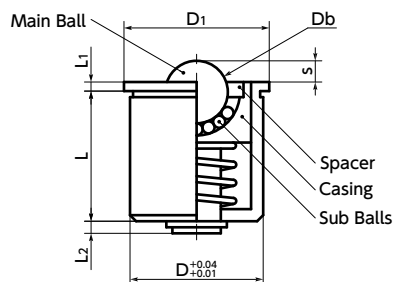

BRPPS-S Ball Rollers with Spring Plunger Function

SUS Stainless steel



⚠ Precautions for Use

- These ball rollers are for upward applications only. If it is used for downward and sideward applications, the product may be damaged or the ball may malfunction.
- The bottom section moves the stroke distance of the main ball. Take care with the depth of the attachment hole.

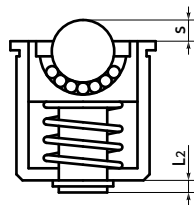

Initial Condition

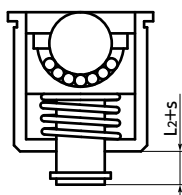

Main Ball at Max. Stroke

- These are press fit type ball rollers with spring plunger function.
- Because the body section is press fitted, the height can be reduced.
- Their internal springs receive loads evenly even when the load is unbalanced.
- These rollers can also be used as a general spring plunger with ball for fixing and locating workpiece. The smooth rotation of the ball reduces friction between the main ball and receiving side.
- Recommended dimensional allowance of attachment hole is H7.

● Application

Conveyance, fixing and locating work, torque limiting, and indexing

● Material/Finish



	BRPPS-S
Main Body	SUS304
Main Ball	SUS440C (Hardness 55HRC or Higher)
Sub Ball	SUS440C (Hardness 55HRC or Higher)
Spacer	SUS304
Casing	SUS304
Spring	SUS631J1

Unit : mm

Part Number	D	D1	L	s	L1	L2	Db	Load (N) Min./Max.	Mass (g)
BRPPS-14-S	14	16	14	1.5	1.5	1.5	5.56	23 / 30	16
BRPPS-18-S	18	20	17	2.5	1.5	2	8.73	24 / 38	31
BRPPS-22-S	22	24	21.5	3.5	1.5	2	10.32	24 / 55	55

● Part number specification

BRPPS-14-S

Product Code: D Stainless Steel Main Ball

Individual Sales → P.xxxx

Cleanroom Wash & Packaging → P.xxxx

Screw Length Adjustment → P.xxxx

Vibration Resistant → P.xxxx

1 piece in 1 pack

Please feel free to contact us

Not Available

Not Available