

SPS-C Plastic Screw - Hex Socket Head Cap Screws - PPS

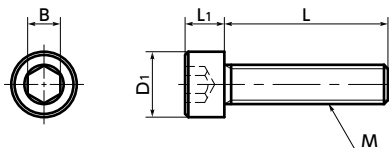

[WEB Selection Tool](#)
[WEB CAD Download](#)
[Heat-resistance](#)
[Chemical-proof](#)



● Material/Finish

RoHS2 Compliant

	SPS-C
Main body	PPS (Polyphenylene Sulfide) /Bright Light Brown Glass Fiber 40%
Heat Resistance Temperature*1	200°C

*1: This is the value for the plastic material. The maximum operating temperature of the product changes with performance conditions such as tightening torque.

- PPS has excellent heat resistance and chemical resistance and continuous duty temperature of 200°C. Under 200°C, no oils, fats, or organic solvents dissolve PPS.
- It has high strength, high rigidity, and high heat resistance strength.
- It has high incombustibility that meets V-0 of UL 94.
- The properties and precautions of plastic screws
➔ P.xxxx

● Application

FPD production equipment, semiconductor devices, printed circuit board etching devices, metallic surface treatment equipment and facilities, chemical plants, transformers, electrical and electronic equipment, hot water pumps, and chemical pumps

Unit : mm

Part Number	M (Coarse)		L								D1	L1	B	Tension*1 Rupture Load (N)	Torsional*1 Torque (N·m)	Mass (g)	
	Nominal of Thread	Pitch	6	8	10	12	15	20	25	30							40
SPS-M3-C	M3	0.5	6	8	10	12	15	20				5.5	3	2.5	558	0.29	0.15 - 0.29
SPS-M4-C	M4	0.7	6	8	10	12	15	20				7	4	3	966	0.69	0.32 - 0.56
SPS-M5-C	M5	0.8		8	10	12	15	20	25	30		8.5	5	4	1548	1.23	0.52 - 1.2
SPS-M6-C	M6	1			10	12	15	20	25	30	40	10	6	5	2028	2.05	1 - 2.3
SPS-M8-C	M8	1.25			10	12	15	20	25	30	40	13	8	6	3701	5.48	2.2 - 4.4

*1: Values in chart are for reference only. They are not guaranteed values. The recommendation torque is 50% of the torsional torque.

Part Number	Qty per pack*1
SPS-M3-C	20
SPS-M4-C	20
SPS-M5-C	10
SPS-M6-C	10
SPS-M8-C	5

*1: Also sold separately from 1 piece up. ➔ P.xxxx

● Part number specification

SPS - M5 - 20 - C

Product Code **1** **2** Product Code

Order in number of packs.

Also sold separately from 1 piece up. ➔ P.xxxx

Individual Sales ➔ P.xxxx	Cleanroom Wash & Packaging ➔ P.xxxx	Screw Length Adjustment ➔ P.xxxx	Vibration Resistant ➔ P.xxxx	Modification process for captive use ➔ P.xxxx
Available / Add'l charge	Available / Add'l charge	Available / Add'l charge	Not Available	Please feel free to contact us