

# SPD-C Plastic Screws - Hex Socket Head Cap Screws - VESPEL (Grade: SP - 1)

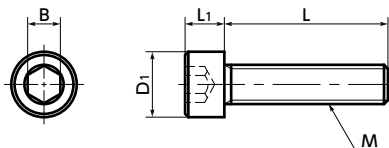

[WEB Selection Tool](#)
[WEB CAD Download](#)
[Cleanroom wash & packaging](#)
[Heat-resistance](#)
[Chemical-proof](#)



## ● Application

FPD production equipment, semiconductor devices, printed circuit board etching devices, metallic surface treatment equipment and facilities, chemical plants, transformers, electrical and electronic equipment, hot water pumps, and chemical pumps

## ● Material/Finish



SPD-C	
Main Body	VESPEL SP-1 (Non-thermoplastic Polyimide Resin)
Heat Resistance Temperature*1	288°C

● VESPEL is a registered trademark of DuPont.

\*1: This is the value for the resin material. The operating temperature of the product changes with performance conditions such as tightening torque.

- VESPEL SP-1 is a non-thermoplastic super-engineering plastic with excellent physical and chemical properties.
- Properties of VESPEL SP-1 → P.xxxx
- It does not reach a softening point, such as its melting point or glass transition point, even under high temperatures and can be used continually at 288°C.
- The screws have excellent chemical resistance, plasma resistance, radiation hardness, and abrasion resistance.
- Thanks to the powder compression molding method, no bubbles blend in and outgas quantity is extremely low. → P.xxxx
- Cleanroom wash and cleanroom packing are completed. → P.xxxx

Unit : mm

Part Number	M (Coarse)		L												D1	L1	B	Torsional*1 Torque (N·m)	Mass (g)	
	Nominal of Thread <span style="color:red">1</span>	Pitch	<span style="color:red">2</span>																	
SPD-M3-C	M3	0.5	6	8	10	12	16									5.5	3	2.5	0.12	0.13 - 0.21
SPD-M4-C	M4	0.7	6	8	10	12	16	20	25							7	4	3	0.27	0.28 - 0.58
SPD-M5-C	M5	0.8		8	10	12	16	20	25	30						8.5	5	4	0.54	0.45 - 1
SPD-M6-C	M6	1			10	12	16	20	25	30	40					10	6	5	0.95	0.86 - 2
SPD-M8-C	M8	1.25			10	12	16	20	25	30	40					13	8	6	2.26	1.9 - 3.8

\*1: Values in chart are for reference only. They are not guaranteed values. The recommendation torque is 50% of the torsional torque.

Part Number	Qty per Pack
SPD-M3-C	1
SPD-M4-C	1
SPD-M5-C	1
SPD-M6-C	1
SPD-M8-C	1

## ● Related Products

**SPDC-C** VESPEL SCP-5000 Hex Socket Head Screw, which has a continuous duty temperature of 350 °C, is available.

→ P.xxxx



## ● Part number specification

### SPD - M5 - 20 - C

Product Code 1 2 Product Code

This is a non-stocked product.

<b>1</b> Individual Sales → P.xxxx	<b>2</b> Cleanroom Wash & Packaging → P.xxxx	<b>3</b> Screw Length Adjustment → P.xxxx	<b>4</b> Vibration Resistant → P.xxxx	<b>5</b> Modification process for captive use → P.xxxx
1 unit in 1 bag	Cleanroom washed and packed	Available / Add'l charge	Not Available	Please feel free to contact us