

SUS Stainless steel

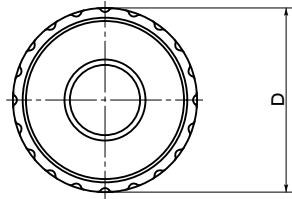

KRM  
KRMS

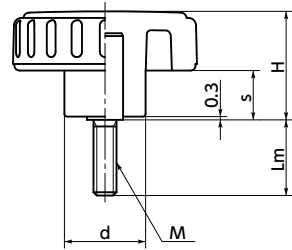

KRF  
KRFS

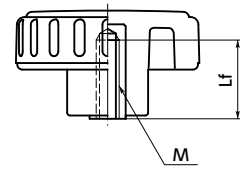

KRR  
Guide hole KRR-\*\*-R\*

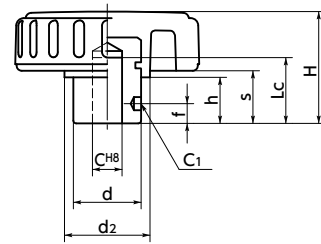

Tap hole KRR-\*\*-R\*\*-\*M\*

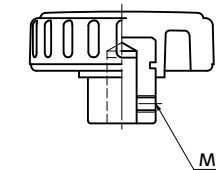

**KRM | KRMS** Male Screw

Unit : mm

Part Number  Made of Steel	Part Number  Made of Stainless Steel	D	M (Coarse)		Lm	H	s	d	Mass (g)
			Nominal of Thread	Pitch					
KRM-25-M4-6		25	M4	0.7	6	19	8	13	6
KRM-25-M4-10		25	M4	0.7	10	19	8	13	7
KRM-25-M4-16		25	M4	0.7	16	19	8	13	7
KRM-32-M5-10	KRMS-32-M5-10	32	M5	0.8	10	22	10	15	11
KRM-32-M5-16	KRMS-32-M5-16	32	M5	0.8	16	22	10	15	12
KRM-32-M5-20	KRMS-32-M5-20	32	M5	0.8	20	22	10	15	12
KRM-32-M6-10		32	M6	1	10	22	10	15	12
KRM-32-M6-20		32	M6	1	20	22	10	15	14
KRM-32-M6-40		32	M6	1	40	22	10	15	19
KRM-40-M6-10	KRMS-40-M6-10	40	M6	1	10	25	11	17	16
KRM-40-M6-16	KRMS-40-M6-16	40	M6	1	16	25	11	17	18
KRM-40-M6-20	KRMS-40-M6-20	40	M6	1	20	25	11	17	18
KRM-40-M6-25	KRMS-40-M6-25	40	M6	1	25	25	11	17	19
KRM-40-M8-16		40	M8	1.25	16	25	11	17	23
KRM-40-M8-20		40	M8	1.25	20	25	11	17	25
KRM-50-M8-16	KRMS-50-M8-16	50	M8	1.25	16	30	13.5	20	29
KRM-50-M8-20	KRMS-50-M8-20	50	M8	1.25	20	30	13.5	20	31
KRM-50-M8-25	KRMS-50-M8-25	50	M8	1.25	25	30	13.5	20	33
KRM-50-M8-30	KRMS-50-M8-30	50	M8	1.25	30	30	13.5	20	35
KRM-50-M8-50		50	M8	1.25	50	30	13.5	20	43
KRM-50-M10-20		50	M10	1.5	20	30	13.5	20	40
KRM-50-M10-30		50	M10	1.5	30	30	13.5	20	46
KRM-63-M10-20		63	M10	1.5	20	35	15	23	55
KRM-63-M10-30	KRMS-63-M10-30	63	M10	1.5	30	35	15	23	61
KRM-63-M10-50	KRMS-63-M10-50	63	M10	1.5	50	35	15	23	73

- Three types including male screws **KRM** and **KRMS**, female screws **KRF** and **KRFS**, and reamed hole type **KRR**.
- Reamed hole type **KRR** hub types available include the fixing pin guide hole type and the tap hole type which goes through to the reamed hole.
- The **KRR** tap hole type is provided with hex socket set screws.
- A wide variety of screw sizes from M4 to M10.
- Types and thread part materials can be selected by a product code.



Product Code	Type	Thread Part Material
<b>KRM</b>	Male Screw	Made of Steel
<b>KRMS</b>	Male Screw	Made of Stainless Steel
<b>KRF</b>	Female Screw	Made of Steel
<b>KRFS</b>	Female Screw	Made of Stainless Steel
<b>KRR</b>	Reamer Bore	Made of Steel

• Material/Finish



	<b>KRM</b>	<b>KRMS</b>	<b>KRF</b>	<b>KRFS</b>	<b>KRR</b>
Knob	Nylon 6 (Matte Black)	Nylon 6 (Matte Black)	Nylon 6 (Matte Black)	Nylon 6 (Matte Black)	Nylon 6 (Matte Black)
Thread part	SWCH10R Trivalent Chromate Treatment	SUSXM7	Steel Trivalent Chromate Treatment	SUS303	—
Hub	—	—	—	—	Steel Ferrosoferric Oxide Film (Black)
Hex Socket Set Screw*1	—	—	—	—	SCM435 Ferrosoferric Oxide Film (Black)

\*1 : Tap hole type only

**KRF | KRFS** Female Screw

Unit : mm

Part Number  Made of Steel	Part Number  Made of Stainless Steel	D	M (Coarse)		Lf	H	s	d	Mass (g)
			Nominal of Thread	Pitch					
<b>KRF-25-M4</b>		25	M4	0.7	8	19	8	13	13
<b>KRF-32-M5</b>	<b>KRFS-32-M5</b>	32	M5	0.8	10	22	10	15	15
<b>KRF-32-M6</b>		32	M6	1	10	22	10	15	15
<b>KRF-40-M6</b>	<b>KRFS-40-M6</b>	40	M6	1	14	25	11	17	17
<b>KRF-40-M8</b>		40	M8	1.25	14	25	11	17	15
<b>KRF-50-M8</b>	<b>KRFS-50-M8</b>	50	M8	1.25	18	30	13.5	20	27
<b>KRF-50-M10</b>		50	M10	1.5	19	30	13.5	20	24
<b>KRF-63-M10</b>	<b>KRFS-63-M10</b>	63	M10	1.5	20	35	15	23	55

**KRR** Reamer Bore

Unit : mm

Part Number  Made of Steel	D	C	Lc	H	C1	M (Coarse)		d2	d	f	h	s	Mass (g)
						Nominal of Thread	Pitch						
<b>KRR-40-R8</b>	40	8	15	25	2.8	—	—	19	14	7	9	11	27
<b>KRR-50-R10</b>	50	10	19	32	2.8	—	—	22	17	8	13	15.5	47
<b>KRR-63-R12</b>	63	12	23	40	3.8	—	—	26	21	10	17	20	91
<b>KRR-40-R8-1-M4</b>	40	8	15	25	—	M4	0.7	19	14	4.5	9	11	30
<b>KRR-50-R10-1-M5</b>	50	10	19	32	—	M5	0.8	22	17	8	13	15.5	50
<b>KRR-63-R12-1-M5</b>	63	12	23	40	—	M5	0.8	26	21	10	17	20	95

• Part Number Specification

**KRMS-32-M5-20**



Cleanroom Wash & Packaging Screw Combination Screw Length Adjustment Vibration Resistant Laser Marking  
Please feel free to contact us Female screw only/ Add'l charge Male screw only/ Add'l charge Male screw only/ Add'l charge Available / Add'l charge