

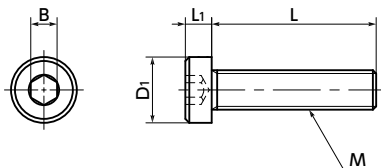

# SPE-LC Plastic screw - Hex Socket Low Head Bolt - PEEK

Protrusion 
 Heat-resistance 
 Chemical-proof



## ● Application

FPD production device / Semiconductor manufacturing device / Print board etching equipment / Metal surface treatment facility / Chemical plant / Transformer / Electric and electronic device / Hydrothermal pump / Chemical pump

## ● Material/Finish



	<b>SPE-LC</b>
Main body	PEEK / Light Brown
Heat resistance temperature*1	260°C

\*1: A value of plastic materials. The allowable operating temperature of the product varies depending on use conditions such as tightening torque.

## ⚠ Precautions for Use

Because a cumulative pitch difference is created when PEEK screws are manufactured, use these screws with nuts. If a nut is not used, use a 20 mm or less fit with female thread.

- Hex socket head cap screw with low head.
- For space-saving of equipment/device and applications with a limited top space.
- PEEK is thermoplastic super engineering plastic superior in physical and chemical properties.
- Excellent chemical resistance. It resists almost all chemicals other than concentrated sulfuric acid, concentrated nitric acid and concentrated hydrofluoric acid.
- It is highly heat-resistant and water-proofed and high temperature strength is retained.
- Features outstanding friction, shock, and fatigue resistance.
- It is highly frame-resistant satisfying V-0 of the UL standard 94.
- Plastic screw properties and precautions for use  
➔ P.xxxx

Unit : mm

Part Number	M (Coarse)		L	D1	L1	B	Tension*1 Rupture Load (N)	Torsional*1 Torque (N·m)	Mass (g)	Qty per pack
	Nominal of Thread	Pitch								
<b>SPE-M3-LC</b>	M3	0.5	6 8 10 12 16 20	5.5	2	2	400	0.13	0.09 - 0.2	10
<b>SPE-M4-LC</b>	M4	0.7	6 8 10 12 16 20 25	7	2.8	2.5	744	0.47	0.19 - 0.46	10
<b>SPE-M5-LC</b>	M5	0.8	6 8 10 12 16 20 25 30	8.5	3.5	3	1272	0.68	0.26 - 0.81	10
<b>SPE-M6-LC</b>	M6	1	10 12 16 20 25 30 40	10	4	4	1727	1.36	0.58 - 1.6	5

\*1: Values in chart are for reference only. They are not guaranteed values. The recommendation torque is 50% of the torsional torque.

● When purchasing less volume than one full bag, a separate handling fee is charged. For details, see the Sold Separately Service.

## ● Related Products

PEEK hexagon nuts **SPE-N** are available.

➔ P.xxxx



## ● Part number specification

**SPE-M5-30-LC**

Product Code **1** **2** Product Code

Individual Sales ➔ P.xxxx	Cleanroom Wash & Packaging ➔ P.xxxx	Screw Length Adjustment ➔ P.xxxx	Vibration Resistant ➔ P.xxxx	Modification process for captive use ➔ P.xxxx
Available / Add'l charge	Available / Add'l charge	Available / Add'l charge	Not Available	Please feel free to contact us