

SPE-C(INCH) Plastic Screws - Hex Socket Head Cap Screws - Inch Thread - PEEK

 Heat-resistance  Chemical-proof

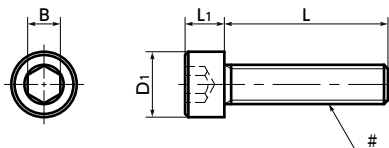

● Material/Finish



	SPE-C(INCH)
Main Body	PEEK / Light Brown
Heat Resistance Temperature*1	260°C

*1: This is the value for the resin material. The operating temperature of the product changes with performance conditions such as tightening torque.

 Precautions for Use

Because a cumulative pitch difference is created when PEEK screws are manufactured, use these screws with nuts. If a nut is not used, use a 20 mm (approx. 0.79") or less fit with female thread.

- Inch screw type.
- PEEK is a thermoplastic super engineering plastic superior in physical and chemical properties.
- Excellent chemical resistance. It remains almost unaffected by chemicals other than concentrated sulfuric acid, concentrated nitric acid, and concentrated hydrofluoric acid.
- With excellent heat resistance and water resistance, it retains strength at high temperatures.
- It features outstanding resistance to wear, shock, and fatigue.
- It also has high flame retardance which clears the UL 94 V-0 standard.
- Plastic screw properties and precautions for use
→ P.xxxx

● Application

FPD production equipment / Semiconductor devices / Printed circuit board etching devices / Metallic surface treatment equipment and facilities / Chemical plants / Transformers / Electrical and electronic equipment / Hot water pumps / Chemical pumps

Unit : inch

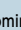
Part Number 	#Nominal of Thread	L 	D1	L1	B	Tension*1 Rupture Load (N)	Torsional*1 Torque (N·m)	Mass (g)	Qty per Pack	
SPE-#4-40-C	No.4-40UNC	1 / 4 5 / 16 3 / 8 1 / 2 5 / 8 3 / 4 7 / 8 1	0.183	0.112	3 / 32	306	0.19	0.075 - 0.26	10	
SPE-#6-32-C	No.6-32UNC	1 / 4 5 / 16 3 / 8 1 / 2 5 / 8 3 / 4 7 / 8 1	0.226	0.138	7 / 64	459	0.33	0.11 - 0.3	10	
SPE-#8-32-C	No.8-32UNC	1 / 4 5 / 16 3 / 8 1 / 2 5 / 8 3 / 4 7 / 8 1	0.27	0.164	9 / 64	746	0.61	0.21 - 0.4	10	
SPE-#10-24-C	No.10-24UNC	3 / 8 1 / 2 5 / 8 3 / 4 7 / 8 1	0.312	0.19	5 / 32	919	0.84	0.33 - 0.46	10	
SPE-#10-32-C	No.10-32UNF	3 / 8 1 / 2 5 / 8 3 / 4 7 / 8 1	0.312	0.19	5 / 32	1090	0.95	0.46 - 0.68	10	
SPE-1 / 4-20-C	1/4-20UNC	3 / 8 1 / 2 5 / 8 3 / 4 7 / 8 1	1 - 1/4	0.375	0.25	3 / 16	1742	2.04	0.58 - 1.1	10

*1: Values in chart are for reference only. They are not guaranteed values. The recommended tightening torque is 50% of the torsional torque.

● When purchasing less volume than one full bag, a separate handling fee is charged. For details, see the Sold Separately Service.





● Related Products

PEEK hex nuts (inch thread)
SPE-N(INCH) are available.

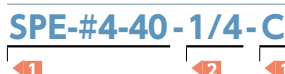

● Part number specification



 Individual Sales → P.xxxx	 Cleanroom Wash & Packaging → P.xxxx	 Screw Length Adjustment → P.xxxx	 Vibration Resistant → P.xxxx	 Modification process for captive use → P.xxxx
Available / Add'l charge	Available / Add'l charge	Available / Add'l charge	Not Available	Please feel free to contact us