

SSCLS Socket Head Cap Captive Screws with Low Profile

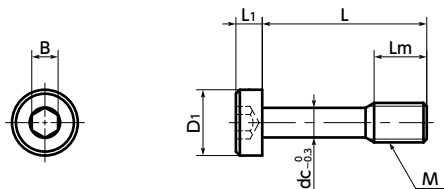

Protrusion **SUS** Stainless steel



⚠ Precautions for Use

- The inner diameter of the screw hole of the cover must be equal or larger than dimension dc.
- The thickness of the cover must be 0.8 mm or more.
- Installation example
Make a screw hole in the cover, then pass **SSCLS** thread through it. Even when the screw is removed from the frame, **SSCLS** does not fall out from the cover because **SSCLS** thread catches on the screw hole of the cover.

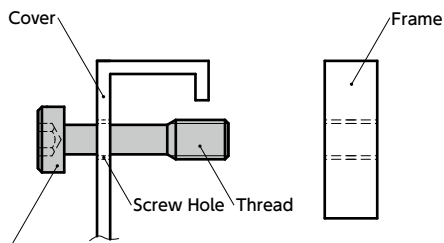

SSCLS Socket Head Cap Captive Screw with Low Profile

- The shape of the screws prevent them from falling out and loss. They are intended to fix protective and inspection covers that are frequently installed and removed.
- These screws are intended for the reduction of the size of machinery and device and applications with limited overhead space.
- These items comply with CE marking requirements.
➔ P.xxxx
- Application

Securement of protective and inspection covers and compliance with CE marked products
Machine tools, food industry machines, and electrical and electronic equipment

• Material/Finish



	SSCLS
Main Body	SUSXM7 (Equivalent to SUS304)
Strength Class	A2-50

Unit : mm

Part Number	M (Coarse)		L	Lm	D1	L1	B	dc	Mass (g)
	Nominal of Thread	Pitch							
SSCLS-M3	M3	0.5	8 10 12 16	4	5.5	2	2	2.2	0.62 - 0.98
SSCLS-M4	M4	0.7	10 12 16 20	5	7	2.8	2.5	3	1.4 - 2.3
SSCLS-M5	M5	0.8	12 16 20 25	6	8.5	3.5	3	3.9	2.3 - 4.1
SSCLS-M6	M6	1	12 16 20 25 30	8	10	4	4	4.5	3.8 - 7.1
SSCLS-M8	M8	1.25	16 20 25 30 35 40	10	13	5	5	6.3	9 - 18

• Part number specification

SSCLS-M6-12

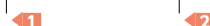

Individual Sales ➔ P.xxxx	Cleanroom Wash & Packaging ➔ P.xxxx	Screw Length Adjustment ➔ P.xxxx	Vibration Resistant ➔ P.xxxx	Modification process for captive use ➔ P.xxxx
1 piece in 1 pack	Available / Add'l charge	Not Available	Not Available	with Captive Processing